

## ESTIMATE WORKSHEET

## SARAH FARMS II

Project Name

20105.1

5/31/2024

LES Project No.

Date Revised

PAVING, CURB, SIDEWALK, EARTH WORK &amp; STORM SEWER

LUCIDO ENGINEERING &amp; SURVEYING, LLC

Engineer

BC SARAH FARMS LLC

Owner/Applicant

Description of Work Proposed

ITEM LIST	DESCRIPTION	QTY.	UNIT	UNIT PRICE	AMOUNT
100.00		0	SY		\$ -
101.00	SUPERPAVE BITUMINOUS CONCRETE WEARING SURFACE LAYER, 1/2" Maximum Aggregate Size Mix, ESAL Range C/D, Approximately 125 lbs per sq.yd.	865	TON	\$ 225.00	\$ 194,625.00
102.00	SUPERPAVE BITUMINOUS CONCRETE UPPER BINDER LAYER, 1" Maximum Aggregate Size Mix, ESAL Range C/D, Approximately 220 lbs per sq.yd.	1601	TON	\$ 225.00	\$ 360,225.00
105.00	8" SUB BASE MIX (SAND/CLAY)	12804	SY	\$ 14.60	\$ 186,938.40
106.00	TACK COAT, ALDOT 405A-000	13636	SY	\$ 7.06	\$ 96,270.16
107.00	ROADSIDE IMPROVEMENT - SOLID SOD (SEED & MULCH, HYDROSEEDING, OR OTHER ALTERNATIVE MEANS OF ESTABLISHING PERMANENT	335	SY	\$ 15.00	\$ 5,025.00
108.00	BORROW EXCAVATION [(A-2-4(0)) or A-4(0)]	300	CY	\$ 12.00	\$ 3,600.00
109.00	UNCLASSIFIED EXCAVATION	664	CYIP	\$ 15.00	\$ 9,960.00
110.00	TOPSOIL STOCKPILE AND RESPREAD	150	CYIP	\$ 15.00	\$ 2,250.00
111.00	2' LAYDOWN CURB	9975	LF	\$ 20.03	\$ 199,799.25
111.01	2' LAYDOWN CURB (MEDIAN AT ENTRANCE)	251	LF	\$ 20.03	\$ 5,027.53
112.00	8' CONCRETE SIDEWALK 4" THICK	4400	SY	\$ 43.55	\$ 191,620.00
113.00	Solid White, Class 2, Type A Traffic Stripe (5" Wide)	1305	LF	\$ 4.98	\$ 6,500.00
114.00	EROSION & SEDIMENT CONTROL MEASURES (WATTLE CHECKS, TEMPORARY SEED/MULCH, INLET PROTECTION, ETC)	1	LS	\$ 7,500.00	\$ 7,500.00
115.00					\$ -
116.00	18" RCP	1658	LF	\$ 95.00	\$ 157,510.00
117.00	24" RCP	1277	LF	\$ 98.00	\$ 125,146.00
118.00	30" RCP	144	LF	\$ 105.00	\$ 15,120.00
119.00	36" RCP	411	LF	\$ 110.00	\$ 45,210.00
119.10	36" RCP (OUTFALL CR-12)	150	LF	\$ 110.00	\$ 16,500.00
120.00	SLOPED CONCRETE HEADWALL (36")	2	EA	\$ 1,500.00	\$ 3,000.00
120.10	GRATE INLET (36")	1	EA	\$ 1,500.00	\$ 1,500.00
121.00	HEADWALL	1	EA	\$ 1,500.00	\$ 1,500.00
122.00	INLET TYPE 1	16	EA	\$ 1,100.00	\$ 17,600.00
123.00	INLET TYPE 2	16	EA	\$ 1,500.00	\$ 24,000.00
124.00	INLET YARD	1	EA	\$ 1,700.00	\$ 1,700.00
125.00	MANHOLE 2	16	EA	\$ 1,850.00	\$ 29,600.00
126.00	MANHOLE 3	3	EA	\$ 2,050.00	\$ 6,150.00

127.00					\$	-
128.00	MES 18	1	EA	\$	750.00	\$ 750.00
129.00	MES 24	2	EA	\$	800.00	\$ 1,600.00
130.00	MES 30	2	EA	\$	950.00	\$ 1,900.00
131.00	MES 36	2	EA	\$	1,000.00	\$ 2,000.00
132.00						\$ -
		1	LS			\$ -
		1	LS			\$ -
		1	LS			\$ -
		1	LS			\$ -

<b>GRAND TOTAL</b>	<b>\$ 1,720,126.34</b>
--------------------	------------------------

**LEGEND: TYPICAL ABBREVIATIONS**

AC ACRES  
 ALDOT ALABAMA DEPARTMENT OF TRANSPORTATION  
 BCHD BALDWIN COUNTY HIGHWAY DEPARTMENT  
 CY CUBIC YARDS - MEASURED IN-PLACE  
 EA EACH  
 IP MEASURED IN-PLACE  
 LF LINEAR FEET

LS LUMP SUM  
 NA NOT APPLICABLE  
 NIC NOT-IN-CONTRACT  
 SY SQUARE YARDS  
 TBM TRUCK BED MEASURE  
 TON TONS

Engineer's estimates are for estimating and informational purposes. Contractor's are responsible for verifying the accuracy of these estimates with the Construction Plans and for verifying actual and/or anticipated field conditions which could result in an increase or decrease in materials and workmanship required to perform work. Please notify the Project Engineer of any errors, omissions, additions and/or incomplete information is noticed, as well as any other questions and/or comments.

PREPARED BY (CONTRACTOR):

CIVIL ENGINEER:  
 Vincent D. Lucido, P.E.  
 (251) 967-3250  
[vincelucido@lucidoeng.com](mailto:vincelucido@lucidoeng.com)

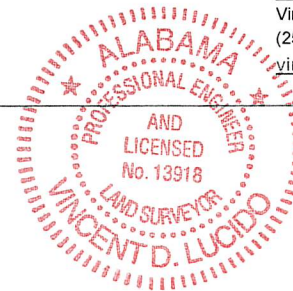

CONTRACTOR'S BID TAB  
 SARAH FARMS II

**ESTIMATE WORKSHEET****CONTRACTOR**

Proposal

Proposal Prepared By

Signature / Title

**SARAH FARMS II**

Project Name

**20105**

LES Project No.

**8/14/2024**

Date Revised

ALDOT Permit No

TURNOUT, RIGHT TURN LANE &amp; STRIPING [ COUNTY ROAD 12 ]

COUNTY ROAD 12 IN FOLEY, ALABAMA

Description of Work Proposed

**LUCIDO ENGINEERING & SURVEYING, LLC**

Engineer

**BC SARAH FARMS**

Owner/Applicant

ITEM LIST	DESCRIPTION	QTY.	UNIT	UNIT PRICE	AMOUNT
<b>TURNOUT &amp; RIGHT TURN LANE IMPROVEMENTS [COUNTY ROAD 12]</b>					
100.00	MILLING OF EXISTING ASPHALT (SAW CUT AND MILLING)	120	SY	\$ 80.00	\$ 9,600.00
101.00	SUPERPAVE BITUMINOUS CONCRETE WEARING SURFACE LAYER, 1/2" Maximum Aggregate Size Mix, ESAL Range C/D, Approximately 135 lbs per sq.yd.	130	TON	\$ 225.00	\$ 29,250.00
102.00	SUPERPAVE BITUMINOUS CONCRETE UPPER BINDER LAYER, 1" Maximum Aggregate Size Mix, ESAL Range C/D, Approximately 250 lbs per sq.yd.	90	TON	\$ 225.00	\$ 20,250.00
105.00	(PRIME COAT) - BITUMINOUS TREATMENT A, ALDOT 401-A, 0.25 GAL/SY	739	SY	\$ 10.00	\$ 7,390.00
106.00	CRUSHED AGGREGATE BASE COURSE, Type B, Plant Mixed, 6" Compacted Thickness	791	SY	\$ 35.00	\$ 27,685.00
107.00	TACK COAT, ALDOT 405A-000	1929	SY	\$ 7.00	\$ 13,503.00
108.00	BORROW EXCAVATION [(A-2-4(0)) or A-4(0)]	300	CY	\$ 5.00	\$ 1,500.00
109.00	UNCLASSIFIED EXCAVATION	664	CYIP	\$ 7.00	\$ 4,648.00
110.00	TOPSOIL STOCKPILE AND RESPREAD	150	CYIP	\$ 4.00	\$ 600.00
111.00	ROADSIDE IMPROVEMENT - SOLID SOD (SEED & MULCH, HYDROSEEDING, OR OTHER ALTERNATIVE MEANS OF ESTABLISHING PERMANENT STABILIZATION OF DISTURBED AREAS ALLOWED ONLY AT THE DISCRETION OF ALDOT)	335	SY	\$ 5.00	\$ 1,675.00
112.00	Solid White, Class 2, Type A Traffic Stripe (18" Wide)	110	LF	\$ 10.50	\$ 1,155.00
113.00	Solid White, Class 2, Type A Traffic Stripe (5" Wide)	1305	LF	\$ 3.50	\$ 4,567.50
114.00	Traffic Control Markings, Class 2, Type A (i.e. "PAVEMENT ARROWS")	10	SF	\$ 39.00	\$ 390.00
<b>SUB-TOTAL</b>				<b>\$ 122,213.50</b>	

GRADING & DRAINAGE IMPROVEMENTS					
210.00	EROSION CONTROL MAT	1200	SF		\$ -
211.00	EROSION & SEDIMENT CONTROL MEASURES (WATTLE CHECKS, TEMPORARY SEED/MULCH, INLET PROTECTION, ETC)	1	LS	\$ 1,200.00	\$ 1,200.00
212.00	TRAFFIC CONTROL MEASURES (CONSTRUCTION SIGNS, CHANNELIZING DRUMS, 36" CONES & BALLASTS, ETC.)	1	LS	\$ 5,500.00	\$ 5,500.00
213.00	MOBILIZATION	1	LS	\$ -	\$ -
214.00	ENGINEERING CONTROL	1	LS	\$ -	\$ -
215.00				\$ -	\$ -
SUB-TOTAL				\$ 6,700.00	
GRAND TOTAL				\$ 128,913.50	

## LEGEND: TYPICAL ABBREVIATIONS

AC ACRES  
ALDOT ALABAMA DEPARTMENT OF TRANSPORTATION  
BCHD BALDWIN COUNTY HIGHWAY DEPARTMENT  
CY CUBIC YARDS - MEASURED IN-PLACE  
EA EACH  
IP MEASURED IN-PLACE  
LF LINEAR FEET

LS LUMP SUM  
NA NOT APPLICABLE  
NIC NOT-IN-CONTRACT  
SY SQUARE YARDS  
TBM TRUCK BED MEASURE  
TON TONS

Engineer's estimates are for estimating and informational purposes. Contractor's are responsible for verifying the accuracy of these estimates with the Construction Plans and for verifying actual and/or anticipated field conditions which could result in an increase or decrease in materials and workmanship required to perform work. Please notify the Project Engineer of any errors, omissions, additions and/or incomplete information is noticed, as well as any other questions and/or comments.

PREPARED BY (CONTRACTOR):

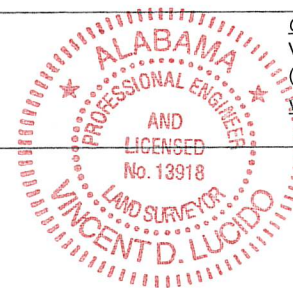

CIVIL ENGINEER:  
Vincent D. Lucido, P.E.  
(251) 967-3250  
[vincelucido@lucidoeng.com](mailto:vincelucido@lucidoeng.com)

*Vincent D. Lucido*  
8/23/2024