

### ALLOWANCE AUTHORIZATION FORM

Project Name: New Sallyport at the Baldwin County Courthouse

Name of Allowance Account: Owner's Allowance

Authorization No.: 5

Date: 5-20-26

In accordance with Specification Section 0101 - "BASE BID, ALTERNATES & ALLOWANCES", the Contractor, Rogers and Willard, is hereby authorized to proceed with the changes in Work as are described below and is to be paid for the performance of these changes as provided in Specification Section 0101. This Authorization shall become effective when it is signed by the Contractor and the Owner's Representative, and it is understood and agreed that the amount(s) stipulated below constitute full compensation for these changes in Work.

Description of the Work under this Authorization: RFP-3 see attached

Total amount of this Authorization: (\$28,455.41)

---

Original amount of the Allowance:	\$200,000.00
Net total of Previous Authorizations:	(\$166,423.27)
Previous Remaining Allowance:	\$33,576.73
Total amount of this Authorization:	(\$28,455.41)

X Allowance Remaining after this Authorization \$5,121.32

Recommended by:

Authorized by:

Accepted by:



\_\_\_\_\_  
ARCHITECT

\_\_\_\_\_  
CITY/COUNT/STATE AGENCY



Digitally signed by Matt Lomax  
DN: C=US,  
E=mlomax@rogerswillard.com,  
O=Rogers and Willard, CN=Matt  
Lomax  
Location: BC Sally Port  
Reason: I am approving this  
document

\_\_\_\_\_  
Contractor





Founded 1957 ♦ Pearson, Humphries, & Jones Architects

Patrick T. Addison, AIA

Harrell G. Gandy, AIA

E. Griffin Harris, AIA

Renis Jones III, AIA

Brian J. Klinkhammer, AIA

Steven R. Hall, AIA

## REQUEST FOR PROPOSAL #3

**Date: May 8, 2026**

**Project: New Sallyport at the  
Baldwin County Courthouse for the  
Baldwin Co. Commission  
Bay Minette, Alabama**

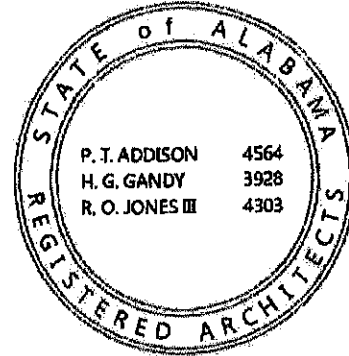

**PH&J No.: 2302-GVA**

**SUBJECT: Required Work Associated with the  
Courthouse Sallyport Project**

**To:**

**Company: Rogers & Willard  
550 Saint Michael Street, Suite A  
Mobile, AL 36602**

**Email: Matt Lomax [mlomax@rogerswillard.com](mailto:mlomax@rogerswillard.com)  
Terry Covas [tcovas@rogerswillard.com](mailto:tcovas@rogerswillard.com)**

**From: Patrick T. Addison**

**Total No. Sheets (Including this one): 6**

Please provide a detailed cost breakdown and proposal for adding the following scope of work. With your proposal, please provide a detailed list and counts associated with the work.

- A. Relocate center two female benches to side wall; one on each side of room
- B. Add "D" ring handcuff restraint on each end of all benches in the male and female benches. They will be thru-bolted into the side of the seat with a plate on front edge exposed and a second on the underside of the bench with bolts rounded head bolt exposed and the nuts on the underside welded to bolt once tightened. - See attachments: RFP3-1
- C. Bolt "D" rings to wall in both Men's and Women's area for extra handcuff and shackle restraints. - See attachments: RFP3-2
- D. Provide In millwork in both entrance areas via the attached elevations and details. - See attachments: RFP3-3
- E. Add a Stainless-steel toilet seat be added to the inmate fixtures in both the male and female restrooms. - See attachments: RFP3-4

- F. Replace generator conduit that is currently supported in the air and have it running along the slab as required and in compliance with code.

If you have any questions, please call.

Thank you,

*Patrick T. Addison*

Patrick T. Addison, Architect

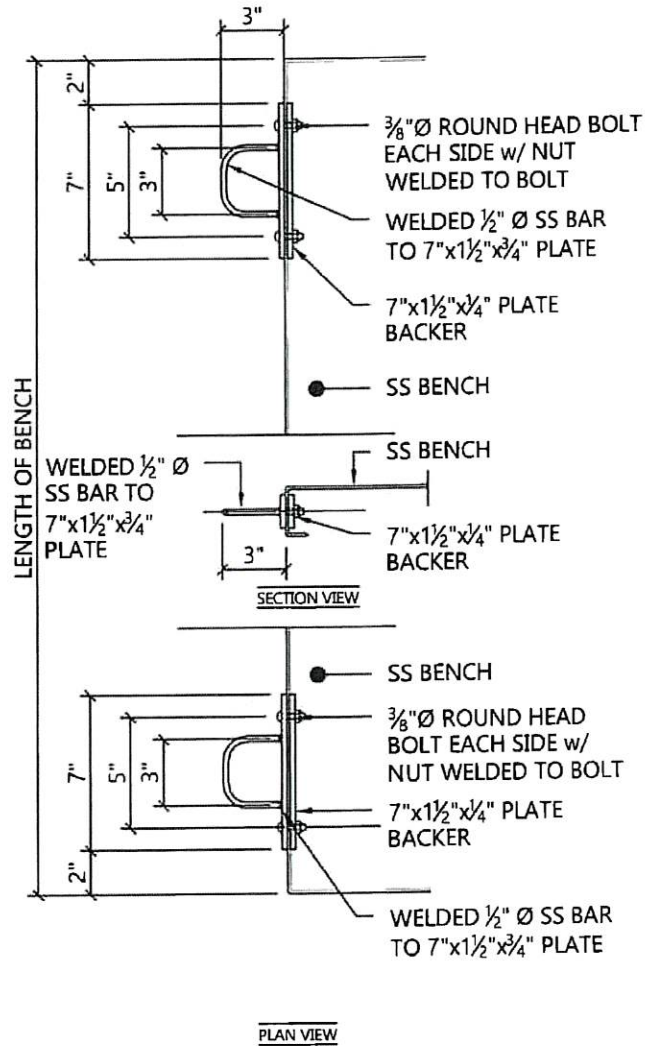

**BENCH BRACKET**

SCALE: 1 1/2" = 1'-0"

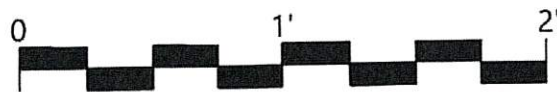

GRAPHIC SCALE

1 1/2" = 1'-0"

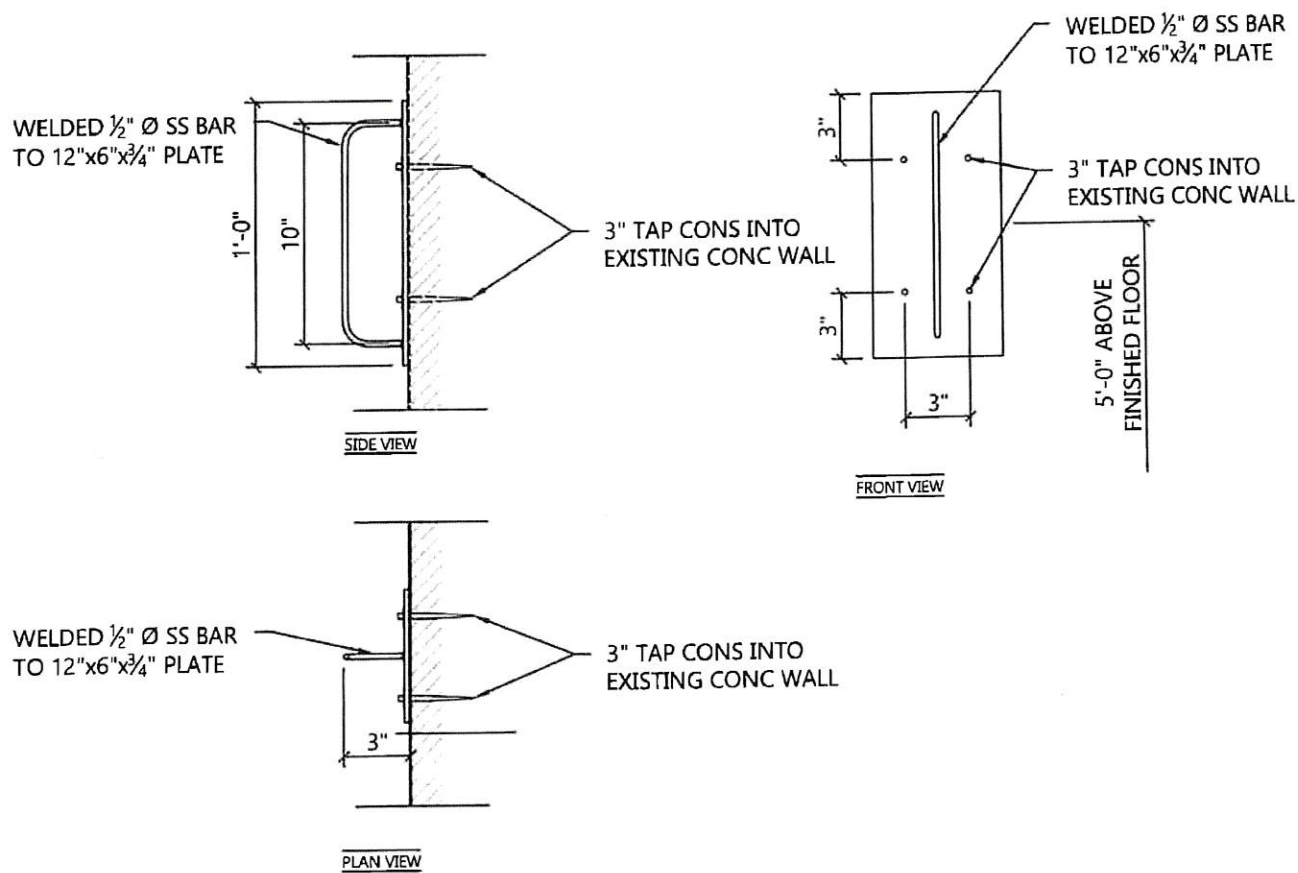

### WALL BRACKET

SCALE: 1 1/2" = 1'-0"

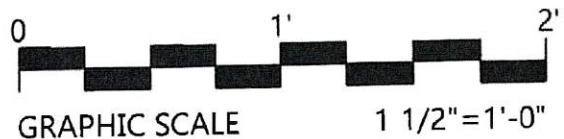

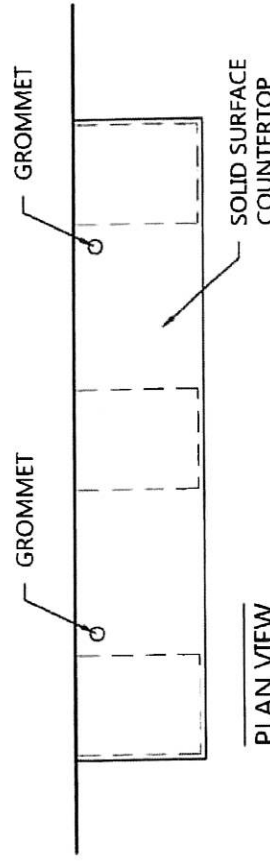
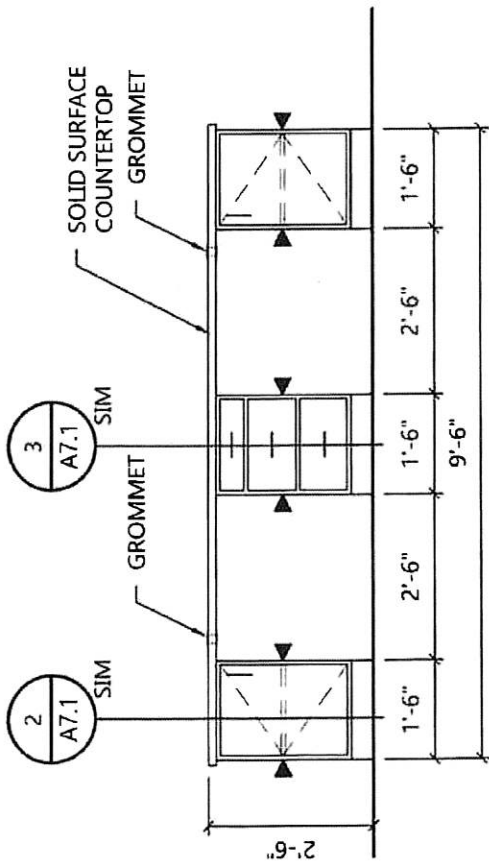
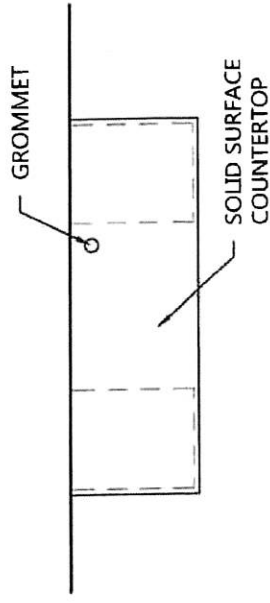
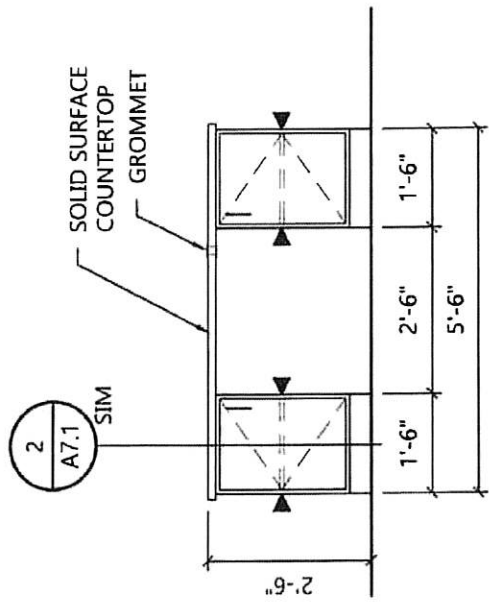

6  
A7.1  
SECURITY STAFF B20  
SCALE: 3/8" = 1'-0"

5  
A7.1  
HOLDING LOBBY B1  
SCALE: 3/8" = 1'-0"

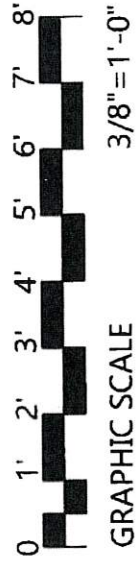

All ▾ stainless steel toilet seat

PLAYOFFS 05 18 27

Tools & Home Improvement Best Sellers Deals & Savings Gift Ideas Power & Hand Tools Lighting & Ceiling Fans Kitchen & Bath Fixtures Smart Home Shop by Room

Shop Professional Smart Toilet

Sponsored

Tools & Home Improvement › Kitchen & Bath Fixtures › Bathroom Fixtures › Toilets & Toilet Parts › Toilet Replacement Parts

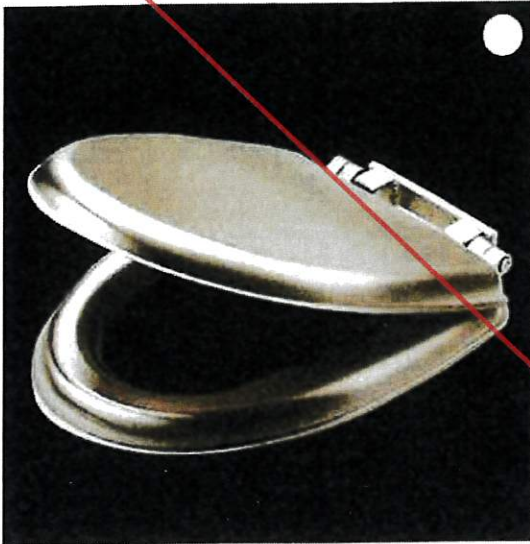

Click to see full view



## HBJWOV Buffer Mute Stainless Steel Toilet Seat Public Facilities Thick Toilet Stainless Steel Toilet Seat

Brand: UOHLCX

\$120<sup>97</sup>

Get \$10 off instantly; Pay \$110.97 ~~\$120.97~~ upon approval for the Amazon Store Card. No annual fee.

**Color** white-Fruit peach5  
**Brand** UOHLCX  
**Item Weight** 2000 Grams  
**Unit Count** 1.0 Count  
**Number of Items** 1  
**Number of Packs** 1

Manufacturer HBJWOV

### About this item

- Waterproof, skin-friendly without harming your skin.
- It is neat, smooth surface, not easy to scrape the skin when using.
- Easy to install. It doesn't take too much time to install the toilet seat cover
- Made of plastic material and a toilet seat lid, it can be used for and practical use.
- The perfect gift for your friends and family.
- Easy to install. It doesn't take too much time to install the toilet seat cover

› See more product details

🚩 Report an issue with this product or seller

### Consider a similar item

Amazon's Choice

\$120<sup>97</sup>

FREE delivery June 2 - 10.  
[Details](#)

Delivering to Montgomery 36107  
 - Update location

**Only 5 left in stock - order soon.**

Quantity: 1

Add to cart

Buy Now

Shipper / Seller Ahan-shop

Returns 30-day refund/replacement

Payment Secure transaction

Add to List

### Other sellers on Amazon

New (5) from \$120<sup>97</sup> & FREE Shipping

Sponsored

Toilet seat changed to standard plastic seat recommended and provided by Willoughby.

Add \$345.00



Date: 5/20/2026

Project:  
Scope: Casework  
General Contractor:

## DEAS MILLWORK

3180 Snow Road North Semmes, AL 36575  
P: 251-478-1060 F: 251-479-7839

Area	Room #	Elevation	Description	unit	qty.
Security Staff	B20	RFP-3	Base Cabinet	lf	3
			Solid Surface CT	sf	15
Holding Lobby	B1	RFP-3	Base Cabinet	lf	5
			Solid Surface CT	sf	25

### GENERAL EXCLUSIONS

- FINISH PAINT BY OTHERS UNLESS PART OF CASEWORK
- ALL SINKS EXCLUDED UNLESS LISTED ABOVE
- BLOCKING BY OTHERS
- ANYTHING CONCEIVED AS FFE EXCLUDED
- ALL METAL UNLESS LISTED ABOVE EXCLUDED
- ALL CAULKING TO DISSIMILAR MATERIALS BY OTHERS
- ALL CABINETS ARE FRAMELESS (EUROPEAN STYLE)
- QUOTE GOOD FOR 30 DAYS
- QUARTZ TO BE FROM DEAS MW STANDARD OFFERINGS
- ALL DECORATIVE TILE WORK BY OTHERS
- ESTIMATE IS BASED ON STRAIGHT TIME HOURS, NO OVERTIME, NO EXPEDITING
- \*\* GC TO VERIFY SCOPE \*\*

Total  
Original Base

**\$9,120.00**



price includes labor and material to fabricate and install listed items.  
Also includes related supervision and required insurance.  
Terms: net 30 days, billed on percentage of completion

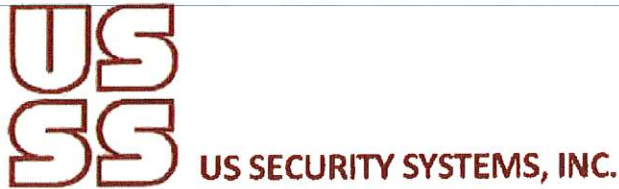

**May 13<sup>th</sup>, 2026 - Change Order Request RFP-03**

To: Rogers & Willard  
Attn: Matt Lomax

Re: Baldwin County Sallyport  
Bay Minette, AL

We propose to "Furnish and Install" the following materials in accordance with the RFP #03 plans and specifications as prepared by PH & J Architects, dated 05/08/2026:

**Scope of Work – RFP-03**

1. Detention Furniture – Cuff Rings
  - Furnish and Install – (32) Cuff Rings to Existing Benches, Stainless Steel.
  - Furnish and Install – (2) Cuff Rings to CMU Wall, Stainless Steel.
  - Remove and Install – (3) Detention Benches

**For the Sum Of: \$13,990.00** Change Order-Add

**Exclusions**

1. We exclude receiving, unloading, distribution of any materials when not performing work on-site.
2. We exclude all final cleaning of glass, metal or other materials furnished and/or installed by our personnel.
3. We exclude the installation of any frames, embeds and grout unless specifically noted otherwise.
4. We exclude all security sealants, caulk and caulking unless specifically noted in above scope.
5. We exclude all special coatings, touch-up of primer and any finish painting.
6. We exclude all duress/CCTV, intercom equipment, conduit, wire, wire pulling and terminations.
7. We exclude ALL louvers, wood doors, standard HM doors/frames/windows, BR rated HM/wood doors, roll-up doors, aluminum storefront, BR rated hardware, core drilling, electrical or plumbing work, any and all demolition work, unless specifically noted in above scope of work.
8. We exclude any and all work not specifically included above.

**Qualifications**

1. **This proposal includes one mobilization only. If US Security mobilizes and the required preliminary work by other trades is not complete upon arrival, travel time will be billed to the General Contractor at a rate of \$85/hour per man.**
2. Cuff Ring Lead Time: Approval Drawings: 4 weeks, Delivery: 10 weeks after approvals.
3. We are not responsible for broken or damaged glass, metal or other materials (except that caused by our own employees), nor for the protection of same after installation.
4. We will provide on-site supervision only while our scope of work is being performed. All construction schedules that involve our work will be mutually established and agreed upon.
5. General Contractor to unload and store all materials 'Furnished Only' under this scope of work.
6. All unloading and storage for material installed under this scope of work is included.

7. Suitable secured, covered, dry storage space is to be supplied for our materials and protection of same.
8. No back-charge will be valid without our prior written agreement.
9. Work area will be in acceptable condition with sufficient lighting and power requirements available.
10. This scope letter is in effect for 30 days from bid date.
11. All contract changes must be finalized in writing prior to work.
12. Taxes are EXCLUDED.

If you have any questions, please feel free to contact this office.

Sincerely,

Jonathan Burleson  
Project Manager

# PROPOSED CHANGE ORDER

**BAGBY & RUSSELL ELECTRIC**

CCN # 2  
 Date: 5/19/2026  
 Project Name: BCCH SALLYPORT  
 Project Number: 24SC2926  
 Page Number: 1

Client Address:

**Work Description**

RFP #3  
 REROUTE CONDUIT TO GENERATOR

**Itemized Breakdown**

Description	Qty	Net Price	U	Total Mat.	Labor	U	Total Hrs.
2" EMT STL COMP CONN	1	900.00	C	9.00	22.50	C	0.23
2" GRC (GALV)	10	1,207.67	C	120.77	14.25	C	1.43
2 GRC NO-THRD CONN	1	2,841.00	C	28.41	28.75	C	0.29
2" GRC MYERS HUB	1	2,836.00	C	28.36	56.25	C	0.56
2" GRC LB CONDULET	1	23.00	E	23.00	1.62	E	1.62
2" GRC 90 ELBOW	2	1,866.25	C	37.33	75.00	C	1.50
2" PVC	50	114.00	C	57.00	10.87	C	5.43
2" PVC FEM ADAPTER	2	183.26	C	3.67	22.50	C	0.45
#6 THHN	70	1,161.57	M	81.31	12.30	M	0.86
#3/0 THHN	280	6,121.87	M	1,714.12	32.00	M	8.96
24"X24"X24" JBOX	1	264.00	E	264.00	3.00	E	3.00
Trenching	1	0.00	E	0.00	8.00	E	8.00
POLARIS CONNECTOR 3/0 2-PORT	4	0.00	E	0.00	0.25	E	1.00
POLARIS CONNECTOR #6 2-PORT	1	0.00	E	0.00	0.25	E	0.25
<b>Totals</b>				<b>2,366.96</b>			<b>33.58</b>

**Summary**

General Materials		2,366.96
<b>Material Total</b>		<b>2,366.96</b>
JOURNEYMAN	(33.58 Hrs @ \$59.00)	1,981.22
<b>Subtotal</b>		<b>4,348.18</b>
Markup	(@ 15.000 %)	652.23
<b>Subtotal</b>		<b>5,000.41</b>
<b>Final Amount</b>		<b>\$5,000.41</b>

**CONTRACTOR CERTIFICATION**

Name:	_____
Date:	_____
Signature:	_____
I hereby certify that this quotation is complete and accurate based on the information provided.	

**CLIENT ACCEPTANCE**

**ORIGINAL**

**PROPOSED CHANGE ORDER**

Client Address:

**BAGBY & RUSSELL ELECTRIC**

**CCN #** 2  
**Date:** 5/19/2028  
**Project Name:** BCCH SALLYPORT  
**Project Number:** 24SC2926  
**Page Number:** 2

<b>CCN #:</b> 2	_____
<b>Final Amount:</b> \$5,000.41	_____
<b>Name:</b>	_____
<b>Date:</b>	_____
<b>Signature:</b>	_____
<b>Change Order #:</b>	_____

I hereby accept this quotation and authorize the contractor to complete the above described work.

**ORIGINAL**