

CABLE PERMIT APPLICATION

Baldwin County Highway Department

Permit No.	25272-C7R
District	
Township	
Range/Section	
Type	

**PERMIT -FOR THE ACCOMODATION OF UTILITY FACILITIES AND
RELOCATION REQUIREMENTS ON PUBLIC-RIGHTS-OF-WAY**

KNOW ALL MEN BY THESE PRESENTS, THIS AGREEMENT (hereinafter referred to as "Agreement"), entered into this the ____ day of _____, 2025, by and between Baldwin County acting through its authorized agents of the Baldwin County Highway Department (hereinafter referred to as "COUNTY") AND Mediacom / Broadband of Indiana, LLC, (hereinafter referred to as the "UTILITY").

WITNESSETH

WHEREAS, the County proposes certain highway improvements and/or Utility desires to have its facilities accommodated on a public right-of-way in Baldwin County, Alabama, and;

WHEREAS, Mediacom cable company is currently authorized to operate pursuant to the terms and conditions of a valid Cable Franchise Agreement with Baldwin County; and,

WHEREAS, the Franchise Agreement between Baldwin County and Mediacom cable company requires a valid bond to be in force for the duration and term of the Franchise Agreement in order to ensure complete and faithful performance of all conditions and obligations found within said Franchise; and,

WHEREAS, specifically in the case of a disturbance of any right-of-way, the Franchise Agreement provides that Mediacom cable company is responsible for, among other things, the restoration of the right-of-way to its pre-disturbed condition, such responsibility being one of the obligations secured by the bonding requirement within the Franchise Agreement.

WHEREAS, the project subject hereto and contained herein is hereby described, designated and/or entitled as:

State of AL Grant Project to install Mediacom Fiber Optic in the county R.O.W. of E River Rd N
approximately 25' off the edge of pavement / traveled way.

Starting near 19099 E River Rd N and continuing North to near 19501 E River Rd N -

Approximately 2,319.01 L.F. of Duct and Fiber

, and;

WHEREAS, the County has granted to the Utility the right to locate its facilities across or along the public highways, and hereby grants to Utility, approval to cross or locate its facilities on the public right-of-way at the location and in the manner as shown on the attached plans and specifications:

NOW THEREFORE, be it agreed as follows:

30" min depth on shoulder 36" min depth under ditch 48" min depth under road 72" min depth under and around cross drains

CABLE PERMIT APPLICATION

ARTICLE I. County Engineer Authority and Least Possible Interference

The Utility agrees to install its facilities on the public right-of-way, as shown by the plans and specifications attached hereto and made a part hereof as Attachment/Exhibit A and/or in accordance with the requirements of County, so as to occasion the least possible interference with the progress of County projects where such installation is within the bounds of an active highway project.

ARTICLE II. County Standards

Utility agrees to conform to the provisions of the current County Standards, as interpreted by the County Engineer, for the Accommodations of Utilities on a public Right-of-way. It is further agreed that the applicable provisions of the laws of the State of Alabama and Baldwin County, Alabama shall govern and be controlling and binding over the provisions of the Agreement.

ARTICLE III. Non -Assignability

With exception to financing agreements, mortgages, security agreements, or other security interests in the facilities permitted hereby, the parties hereto shall not, without the express written consent of each and every other party hereto, assign, sell, transfer or otherwise any interest, rights or obligations provided or contained herein in whole or in part at any time.

ARTICLE IV. Warranties, Representations and Certifications

The execution and delivery of this Agreement have been duly authorized by all necessary actions of County and Utility, and such actions are in compliance with all public bidding and other State and federal laws applicable.

This Agreement has been duly executed and delivered by, and constitutes the valid and binding obligation of, all parties and enforceable against them in accordance with the respective terms contained herein.

The execution, delivery and performance of this Agreement shall not violate any State, federal, local law, ordinance, order, writ, injunction, decree, or regulation of any court, or conflict with any other obligation of the parties hereto.

Utility shall provide to County, and to the satisfaction of the County Engineer, written proof of compliance with applicable ADEM requirements including a Receipt of Registration from ADEM for Phase II Stormwater Permitting Requirements if applicable.

CABLE PERMIT APPLICATION

If registration of the project with ADEM is not required, under current stormwater Permitting Regulations as determined by the Utility, then it shall be a County requirement that Utility must provide a "written certification of review and understanding" of those same requirements to County as part of this Permit Application.

Notwithstanding the above, Utility shall comply with all applicable environmental laws, regulations and permitting requirements.

ARTICLE V. Term and Binding Effect

This Agreement and contract will, upon County approval and execution:

1. continue in effect until amended, altered to that effect, or otherwise changed by all parties hereto and as required herein, and;
2. Not extend or be enforceable past a maximum of 36 months in duration or shorter time agreed upon by parties as noted herein within Article XXII.

Utility shall remain in compliance for the duration of the terms as listed within this permit to include but not limited to a one-year period after the completion of construction as determined by County, and;

3. Be binding upon and shall inure to the benefit of the County, Utility and their respective agents and successors.

ARTICLE VI. Exhibits and Attachments

The following exhibits and/or attachments listed below referenced herein are specifically included as a necessary part of this agreement and the same shall not be complete without such items, to wit:

- A. Plans and Specifications, Cross Section, Vicinity Map
- B. ADEM compliance certifications or written Certification of Review & Understanding of ADEM regulations as required by ARTICLE IV herein
- C. Letter from applicable Wastewater Treatment Facility confirming knowledge of Utility installation and ability to treat the waste (Sewer Permits only)
- D. Certificate of Insurance (Baldwin County Highway Department as "Certificate Holder" only)
- E. Construction Schedule
- F. _____

CABLE PERMIT APPLICATION

County and Utility jointly shall cause such items as listed above to contain dates, signatures of the parties with authorization to make such signatures, and sufficient marks and references back to this Agreement noting their inclusion and attachment hereto.

ARTICLE VII. Plans

All permits shall include a plan view of the entire utility installation depicting the linear position of the utility along the roadway and the horizontal position of the utility measured to the edge of the roadway. These plans shall also show all roadway crossings as well as the proposed location of any appurtenances such as fire hydrants, pressure relief valves, pedestals, lift stations, etc. The plans shall also include a typical cross section showing the roadway and position of the proposed utility relating to its horizontal and vertical position.

ARTICLE VIII. Entire Agreement

This agreement constitutes the entire agreement of the parties with respect to the subject matter hereof and supersedes all prior and contemporaneous writings, understandings, sketches, drawings, plans, agreements, representations whatsoever whether express or implied.

ARTICLE IX. Severability

In the event that any provision of this Agreement shall be held invalid or unenforceable by a recognized authority or any court of competent jurisdiction, such holding shall not invalidate or render unenforceable any other provision contained herein.

ARTICLE X. Bond Requirements

The Utility agrees to file with the Baldwin County Highway Department a certified check or bond in the amount of \$ N / A made payable to the Baldwin County Highway Department to guarantee the faithful and complete performance of provisions of this Agreement and to guarantee that Utility will maintain this work suitable to the Baldwin County Highway Department for a period of one year.

At the end of one year, from the completion of this work, the Baldwin County Highway Department may:

1. If the work is determined to be satisfactory by County, return the bond or certified check to the remitter, or;
2. If the work is determined to be unsatisfactory, apply the bond or certified check to the cost of repairing the right-of-way with County forces, and;
3. The County has the authority to determine if a bond is required, depending upon the circumstances of the permit.

CABLE PERMIT APPLICATION

ARTICLE XI. Bond Amounts and Reservations

The following are the values for the bond amounts for the following facilities:

- A. Buried Cable
 - 1. Crossing \$5,000
 - 2. Parallel, Trench \$5,000 per mile
 - 3. Parallel, Direct Burial \$2,000 per mile
- B. High-pressure, gas pipelines
 - 1. Crossing highway
 - I. 8-inch diameter and smaller \$10,000
 - II. 10 through 16-inch diameters \$25,000
 - III. Larger than 16 inches \$50,000
 - 2. Parallel to highway
 - I. 8-inch diameter and smaller \$5,000 per mile
 - II. 10 through 16-inch diameters \$25,000 per mile
 - III. Larger than 16 inches \$20,000 per mile
- C. Low-pressure water, sewer, and gas pipelines
 - 1. Crossing highway \$5,000
 - 2. Parallel to highway \$5,000 per mile
- D. For unpaved roadway - above amounts may be reduced by as much as 75% at the discretion of County.
- E. The County reserves the right to increase or decrease the bond requirement to coincide with local conditions and work history of the constructing entity.
- F. As determined on a case-by-case basis, permits issued to entities operating pursuant to a valid Baldwin County Cable Franchise Agreement may not be required to obtain an additional bond for activities permitted herein.

ARTICLE XII. Required Relocation of Facilities

As a condition for permission to install its facilities upon County right-of-ways, Utility agrees to relocate said facilities at Utilities said expense with no obligations imposed upon County financially or otherwise in the event such future relocation is required by County due to upgrading or reconstruction of the road upon which the facilities are located. Utility further agrees to relocate said facilities within 60 days or as determined by County, if such relocation is required.

ARTICLE XIII. Exclusions, Liabilities, and Damages

County, in approving this application, does not in any way assume responsibility for the maintenance of this facility and projects subject hereto. County shall not be responsible for any claims for damage done to existing private property, public utilities or the traveling public caused by Utility, its agents, servants or employees or caused by the facility itself.

CABLE PERMIT APPLICATION

Utility, for the benefits received herein and hereby acknowledged by Utility, agrees to release, indemnify and hold harmless County for any and all deficiencies, court orders, citations, violations, consent orders, fines, or other enforcement actions for refusals or work conducted by the Utility and/or their agents and assigns, all relating to work either resulting from, or specifically relating to the work on County rights-of-ways as herein described or otherwise performed with or without authorization.

County shall be reimbursed or otherwise indemnified from Utility all costs for damages, repairs, fines incurred as a result of any action and/or inaction that would cause County to finish, correct, alleviate, or work on a project/task deemed by County to be the responsibility of Utility. Reimbursement shall come from the Utility in the form of direct payment based on the expenses incurred by the County or through the redeeming of the Bond held by the County in the name of the Utility for said Project.

ARTICLE XIV. Plans on Site

The Utility owner agrees to have an accurate copy of the approved agreement and plans on the job site at all times while said work is being performed.

ARTICLE XV. Responsibility for Traffic Control Devices

Traffic control devices will be installed and maintained in accordance with the Manual on Uniform Traffic Control Devices, latest edition, which is hereby made a part hereof by reference and will be conformed to as the provision thereof, are applicable to such work or otherwise deemed necessary by County.

ARTICLE XVI. Markings and Decals

Utility Company must mark ped or pole with de-cal showing:

- A. Name of company, nature of utility (water, sewer, gas, cable TV, etc.), and;
- B. A telephone number where utility company can be reached by phone, and;
- C. The distance from ped or pole to existing buried line, and;
- D. This applies to existing ped, pole and line, as well as new lines.

ARTICLE XVII. Implementation of Work

Utility must begin work (to the satisfaction of County) on the project no later than 90 days from dated issue of permit, or in the alternative, notify County utilities inspector in writing for consideration of a discretionary extension for good cause.

CABLE PERMIT APPLICATION

ARTICLE XVIII. Site Restoration

All disturbed areas must be returned to as close to normal as possible to include but not limited to reseeding with grass seeds, sod, etc. unless the utility is buried inside a dirt road that is a travel way; however, Utility should always maintain site so as to prevent erosion or otherwise comply with environmental standards. Post-construction drainage, flow direction and volume should be the same as pre-construction drainage, flow direction and volume.

ARTICLE XIX. Non- Waiver

The waiver of any breach of this agreement by County shall not constitute a continuing waiver or a waiver of any subsequent breach, either of the same or another provision of this contract. The delay or omission by County to exercise any right or power provided by this agreement shall not constitute a waiver of such right or power, or acquiescence in any action or inaction on the part of Utility. Any breach on the part of Utility shall be construed a continuing breach, and County may exercise every right and power under the Agreement at any time during the action or inaction or upon the occurrence of any subsequent breach.

ARTICLE XX. Mandatory Time of Contact

Utility agrees to place calls for construction to the County at least 24 hours prior to construction and upon completion.

ARTICLE XXI. Non-Endorsement

County, in no way, is deemed to have approved, provided, given, or allowed to be given any authorization, endorsement, approval, or consent of the business practices, actions or behavior of the Utility. This permit governs and creates an understanding as to the issues herein outlined, or otherwise controls the placement of facilities within the County right-of-way by Utility. Any perceived endorsement, authorization or approval, given hereby, verbally or otherwise, for other business practices or behavior of the Utility or its agents, without a properly-authorized and written verification thereof, is to be considered hereby withdrawn. This permit, and/or the procedures approving the same, is no way to be considered as a substitute for any regulations, procedure or other requirement of County. It is the sole responsibility of the Applicant hereto to comply or to ensure their own compliance with any local, State, or Federal law or regulation.

ARTICLE XXII. Additionally Agreed Upon Provisions

The bonding requirement herein shall be deemed satisfied if the UTILITY has procured, and only during the validity of, a current and valid bond as required by the Baldwin County Franchise Agreement. Should the Franchise bond expire or otherwise be invalidated during the term of this Permit, the UTILITY shall be subject to the bonding requirements hereunder. Further, the UTILITY shall ensure that a County-approved bond is in full force and effect during all periods under this Permit.

CABLE PERMIT APPLICATION

IN WITNESS WHEREOF, the parties hereto have executed this Agreement by their duly authorized officers.

APPROVED BY:

Authorized Representative Date
Baldwin County Highway Department

Permit Manager Date
Baldwin County Highway Department

County Engineer Date
Baldwin County Highway Department

BALDWIN COUNTY HIGHWAY DEPARTMENT
UTILITY PERMITS
PO Box 220
Silverhill, AL 36576
251-972-6831, phone
251-972-6832, fax

APPLICANT:

BY

SIGNATURE

Blake Deslone

TYPED OR PRINTED NAME

Construction Manager

TITLE

Mediacom / Broadband of Indiana, LLC

UTILITY COMPANY (IF APPLICABLE)

ADDRESS:

22448 Doc McDuffie Rd

Foley, AL 36535

(251) 635-4168

PHONE NUMBER

I, Lauren Thompson, a Notary Public in and for said County, in said State, hereby certify that Blake Deslone, an individual whose name as a duly authorized representative for Utility is signed to the foregoing Agreement, and who is known to me, acknowledged before me on this day that, being informed of the contents of the Agreement, he, as such officer and with full authority, executed the same voluntarily for and as the act of said Utility.

Given under my hand and official seal, this the 3rd day of June, 2025.

Lauren Thompson, Notary Public

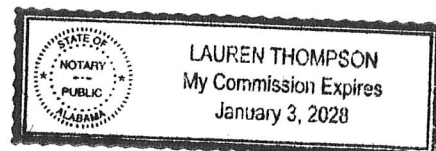

Typical Bore Detail

EXHIBIT A

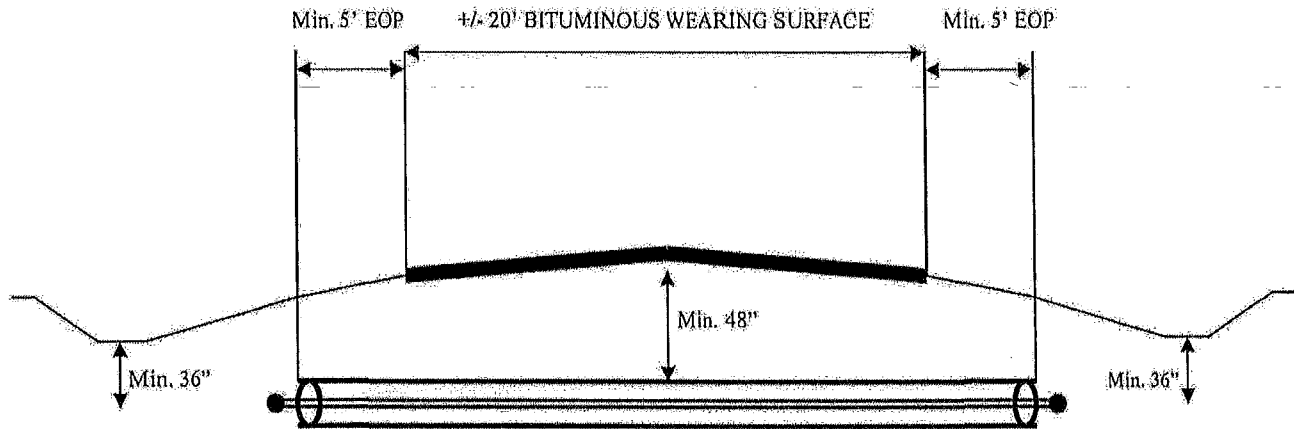

Bore detail for E River Rd N
(County Road name)

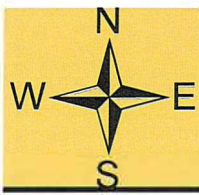

Permit #25272-CTV - East River Road N

Vicinity Map

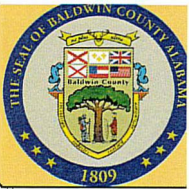

LEGEND

Surface Type

— Paved

— Unpaved

Type

— CATV

— 911 Road Centerlines

— BOXCULVERT

— CROSSDRAIN

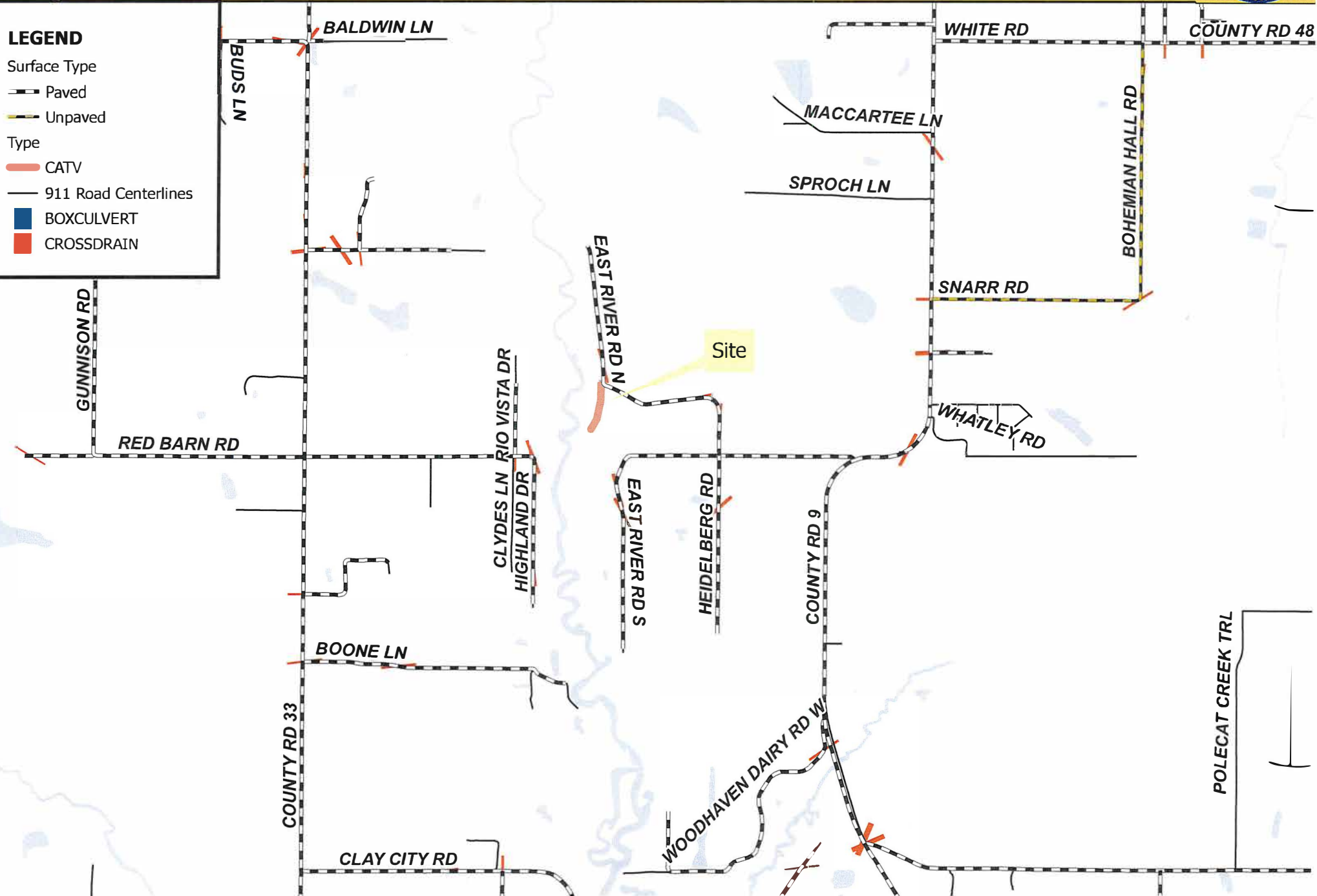

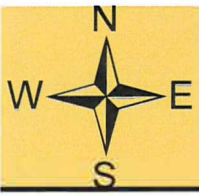

Permit #25272-CTV - East River Road N



Site Map

LEGEND

Surface Type

— Paved

Type

— CATV

— 911 Road Centerlines

— Parcels

— CROSSDRAIN

619 feet of fiber cable

- 16 inch HDPE encasement pipe
- 30 inch min depth on shoulder
- 36 inch min depth under a ditch
- 48 inch min depth under the road
- 72 inch min depth under a cross-drain

EAST RIVER RD N

HEIDELBERG RD

Written Certification and Review of Understanding
of ADEM compliance

6-3-25

(Current Date)

Baldwin County Highway Department
Engineering Division – Utility Inspection
PO Box 220
Silverhill, AL 36576

RE: E River Rd N
(Project Location – Baldwin County)

We have reviewed and understand the Alabama Department of Environmental Management's NPDES stormwater permitting regulations. We hereby certify that the referenced project does not warrant registration.

Sincerely,

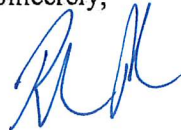

Signature

Blake Deslonde

Typed or Printed Name

Construction Manager

Title



CERTIFICATE OF LIABILITY INSURANCE

DATE (MM/DD/YYYY)

3/19/2025

THIS CERTIFICATE IS ISSUED AS A MATTER OF INFORMATION ONLY AND CONFERS NO RIGHTS UPON THE CERTIFICATE HOLDER. THIS CERTIFICATE DOES NOT AFFIRMATIVELY OR NEGATIVELY AMEND, EXTEND OR ALTER THE COVERAGE AFFORDED BY THE POLICIES BELOW. THIS CERTIFICATE OF INSURANCE DOES NOT CONSTITUTE A CONTRACT BETWEEN THE ISSUING INSURER(S), AUTHORIZED REPRESENTATIVE OR PRODUCER, AND THE CERTIFICATE HOLDER.

IMPORTANT: If the certificate holder is an ADDITIONAL INSURED, the policy(ies) must have ADDITIONAL INSURED provisions or be endorsed. If SUBROGATION IS WAIVED, subject to the terms and conditions of the policy, certain policies may require an endorsement. A statement on this certificate does not confer rights to the certificate holder in lieu of such endorsement(s).

PRODUCER Edgewood Partners Ins Center 1140 Avenue of the Americas, 8th Floor New York NY 10036	CONTACT NAME: Certificate Unit PHONE (A/C, No, Ext): 404-439-8000 FAX (A/C, No): E-MAIL: certificate@epicbrokers.com ADDRESS:														
INSURED Mediacom Southeast LLC One Mediacom Way Mediacom Park, NY 10918	License#: 0B29370 MEDICOM1 <table border="1" style="width: 100%; border-collapse: collapse;"> <thead> <tr> <th style="text-align: left;">INSURER(S) AFFORDING COVERAGE</th> <th style="text-align: left;">NAIC #</th> </tr> </thead> <tbody> <tr> <td>INSURER A : Travelers Property Casualty Co of Amer</td> <td>25674</td> </tr> <tr> <td>INSURER B : The Travelers Indemnity Company of CT</td> <td>25682</td> </tr> <tr> <td>INSURER C : Gemini Insurance Company</td> <td>10833</td> </tr> <tr> <td>INSURER D : AXIS Surplus Insurance Company</td> <td>26620</td> </tr> <tr> <td>INSURER E : Homesite Insurance Company</td> <td>17221</td> </tr> <tr> <td>INSURER F : The Travelers Indemnity Company</td> <td>25658</td> </tr> </tbody> </table>	INSURER(S) AFFORDING COVERAGE	NAIC #	INSURER A : Travelers Property Casualty Co of Amer	25674	INSURER B : The Travelers Indemnity Company of CT	25682	INSURER C : Gemini Insurance Company	10833	INSURER D : AXIS Surplus Insurance Company	26620	INSURER E : Homesite Insurance Company	17221	INSURER F : The Travelers Indemnity Company	25658
INSURER(S) AFFORDING COVERAGE	NAIC #														
INSURER A : Travelers Property Casualty Co of Amer	25674														
INSURER B : The Travelers Indemnity Company of CT	25682														
INSURER C : Gemini Insurance Company	10833														
INSURER D : AXIS Surplus Insurance Company	26620														
INSURER E : Homesite Insurance Company	17221														
INSURER F : The Travelers Indemnity Company	25658														

COVERAGES

CERTIFICATE NUMBER: 53983702

REVISION NUMBER:

THIS IS TO CERTIFY THAT THE POLICIES OF INSURANCE LISTED BELOW HAVE BEEN ISSUED TO THE INSURED NAMED ABOVE FOR THE POLICY PERIOD INDICATED. NOTWITHSTANDING ANY REQUIREMENT, TERM OR CONDITION OF ANY CONTRACT OR OTHER DOCUMENT WITH RESPECT TO WHICH THIS CERTIFICATE MAY BE ISSUED OR MAY PERTAIN, THE INSURANCE AFFORDED BY THE POLICIES DESCRIBED HEREIN IS SUBJECT TO ALL THE TERMS, EXCLUSIONS AND CONDITIONS OF SUCH POLICIES. LIMITS SHOWN MAY HAVE BEEN REDUCED BY PAID CLAIMS.

INSR LTR	TYPE OF INSURANCE	ADDL SUBR INSD WVD	POLICY NUMBER	POLICY EFF (MM/DD/YYYY)	POLICY EXP (MM/DD/YYYY)	LIMITS
A	<input checked="" type="checkbox"/> COMMERCIAL GENERAL LIABILITY <input type="checkbox"/> CLAIMS-MADE <input checked="" type="checkbox"/> OCCUR <input checked="" type="checkbox"/> Deductible \$500,000 GEN'L AGGREGATE LIMIT APPLIES PER: <input type="checkbox"/> POLICY <input checked="" type="checkbox"/> PRO-JECT <input type="checkbox"/> LOC OTHER:			3/1/2025	3/1/2026	EACH OCCURRENCE \$ 1,000,000 DAMAGE TO RENTED PREMISES (Ea occurrence) \$ 500,000 MED EXP (Any one person) \$ 5,000 PERSONAL & ADV INJURY \$ 1,000,000 GENERAL AGGREGATE \$ 2,000,000 PRODUCTS - COMP/OP AGG \$ 2,000,000 \$
A	AUTOMOBILE LIABILITY <input checked="" type="checkbox"/> ANY AUTO <input checked="" type="checkbox"/> OWNED AUTOS ONLY <input type="checkbox"/> SCHEDULED AUTOS <input checked="" type="checkbox"/> HIRED AUTOS ONLY <input checked="" type="checkbox"/> NON-OWNED AUTOS ONLY <input checked="" type="checkbox"/> Deductible \$500,000			3/1/2025	3/1/2026	COMBINED SINGLE LIMIT (Ea accident) \$ 2,000,000 BODILY INJURY (Per person) \$ BODILY INJURY (Per accident) \$ PROPERTY DAMAGE (Per accident) \$ \$
D	<input checked="" type="checkbox"/> UMBRELLA LIAB <input checked="" type="checkbox"/> OCCUR <input type="checkbox"/> EXCESS LIAB <input type="checkbox"/> CLAIMS-MADE DED RETENTION \$			3/14/2025	3/1/2026	EACH OCCURRENCE \$ 2,000,000 AGGREGATE \$ 2,000,000 \$
B A	WORKERS COMPENSATION AND EMPLOYERS' LIABILITY ANY PROPRIETOR/PARTNER/EXECUTIVE OFFICER/MEMBER EXCLUDED? (Mandatory in NH) If yes, describe under DESCRIPTION OF OPERATIONS below	Y/N N	N/A	3/1/2025 3/1/2025	3/1/2026 3/1/2026	<input checked="" type="checkbox"/> PER STATUTE <input type="checkbox"/> OTH-ER E.L. EACH ACCIDENT \$ 1,000,000 E.L. DISEASE - EA EMPLOYEE \$ 1,000,000 E.L. DISEASE - POLICY LIMIT \$ 1,000,000
C E F	Excess Auto Excess Liability Excess Liability			3/1/2025 3/14/2025 3/14/2025	3/1/2026 3/1/2026 3/1/2026	Excess Auto 3,000,000 Occ/Agg \$3M/\$3M Occ/Agg \$5M/\$5M

DESCRIPTION OF OPERATIONS / LOCATIONS / VEHICLES (ACORD 101, Additional Remarks Schedule, may be attached if more space is required)

Excess Layer: Policy #140000975 | QBE Insurance Corporation | NAIC #39217 | \$5M Per Occurrence \$5M Aggregate | Policy Term 3/14/2025 - 3/1/2026
 Baldwin County Commission, to the extent required by written contract, are additional insured with respect to General Liability.

CERTIFICATE HOLDER

CANCELLATION

Baldwin County Commission Baldwin County Highway
 Department Engineering Dept.
 P.O. Box 220 SI AL
 36576

SHOULD ANY OF THE ABOVE DESCRIBED POLICIES BE CANCELLED BEFORE THE EXPIRATION DATE THEREOF, NOTICE WILL BE DELIVERED IN ACCORDANCE WITH THE POLICY PROVISIONS.

AUTHORIZED REPRESENTATIVE

© 1988-2015 ACORD CORPORATION. All rights reserved.

EXHIBIT E

CONSTRUCTION SCHEDULE

Construction on County ROW will begin _____ upon approval _____ and will
take approximately 30 days weeks to complete.

GENERAL NOTES

- ROADS, PAVED DRIVEWAYS AND SIDEWALK CROSSING SHALL BE BORED TO A MINIMUM DEPTH OF 48" UNLESS NOTED OTHERWISE WITHIN THIS SET.
- DISTANCES AND FOOTAGES ARE SHOWN AS APPROXIMATES ONLY. CONTRACTOR WILL FIELD VERIFY CONDITIONS, UTILITY LOCATES, AND MATERIALS NEEDED PER THE PROVIDED MEDIACOM B.O.M. PRIOR TO CONSTRUCTION.
- TRAFFIC CONTROL SHALL BE IN ACCORDANCE WITH THE LATEST EDITION OF THE MANUAL ON UNIFORM TRAFFIC CONTROL DEVICES (MUTCD). CONTRACTOR TO OBTAIN ALL APPLICABLE PERMITS FOR NOTICE TO PROCEED, EXCAVATION AND/OR LANE CLOSURE NOT INCLUDED WITHIN THE PERMIT APPROVED FOR THIS DRAWING SET.
- THERE ARE NO LANE CLOSURES ANTICIPATED WITH THIS PROJECT.
- RESTORATION SHALL BE COMPLETED BY CONTRACTOR IN ACCORDANCE WITH LOCAL JURISDICTIONAL REQUIREMENTS. AT A MINIMUM IF NO REQUIREMENTS ARE AVAILABLE PLEASE REFERENCE NOTES SHOWN ON SHEET 3 OF 9

PROJECT TEAM

UTILITY PROVIDER:	MEDIACOM	BRANT CLOWERS - bclowers@mediacomcc.com - (229) 244-3852
DESIGN FIRM:	WAVELENGTH SERVICES	GARY TEDDER - onecall@wavelengthservices.net - (815) 931-5288
CONTRACTOR:	WAVELENGTH	JEFF PFAFF - jeff@wavelengthservices.net - (815) 931-5288
DOT JURISDICTION:	SW REGION DIST. 92	BAY MINETTE - N/A - (251) 937-2086
COUNTY JURISDICTION:	BALDWIN COUNTY	BALDWIN COUNTY ENGINEERING - FRANK LUNDY, P.E. - (251) 937-0371
TOWNSHIP:	ROBERTSON TWP	N/A - N/A - N/A
RAILROAD COMPANY (IF APPLICABLE)	N/A	N/A - N/A - N/A

PROJECT INFORMATION

DESIGN LOCATE CONTACTS			SERVICE ADDRESS:	E RIVER RD. N
AT&T	N/A	N/A	LINEAR FOOTAGE BORE:	VARIES
N/A	N/A	N/A	LINEAR FOOTAGE PLOW:	VARIES
N/A	N/A	N/A	TOTAL PERMIT PLAN L.F.:	2,319.01 L.F. (0.44 MILES)
N/A	N/A	N/A	HDPE SDR 11 DUCT SIZE:	1.5"
N/A	N/A	N/A	INSTALL TYPE:	SEE PLAN SHEETS
N/A	N/A	N/A	DOT PLAN REFERENCE:	N/A
N/A	N/A	N/A	ROUTE START LAT:	30° 30' 09.48"
N/A	N/A	N/A	ROUTE START LONG:	-87° 48' 25.08"
N/A	N/A	N/A	ROUTE END LAT:	30° 30' 32.04"
N/A	N/A	N/A	ROUTE END LONG:	-87° 48' 25.68"
N/A	N/A	N/A	TOWNSHIP	TOWNSHIP 6S
N/A	N/A	N/A	RANGE(S)	RANGE 3E
N/A	N/A	N/A	SECTION(S)	SECTION 19
ALABAMA ONE CALL DESIGN LOCATE TICKET: N/A				

DESCRIPTION OF WORK

PROPOSED FIBER OPTIC CABLE APPROXIMATELY ±2,319.01 L.F. TO BE LOCATED WITHIN THE COUNTY R.O.W. IN, BALDWIN COUNTY - TOWNSHIP 6S, RANGE 3E



STATE MAP LOCATION

CONTRACTOR NOTE

DEVIATIONS FROM ROUTE SHOWN ON PLAN DUE TO FIELD CONDITIONS SHALL BE NOTED AND UPDATED ON DRAWING SET BY ENGINEERING FIRM. THE UPDATED AS-BUILT DRAWINGS WILL BE PROVIDED TO THE COUNTY ENGINEER AT THE COMPLETION OF THE PROPOSED INSTALLATION.

LOCATION MAP

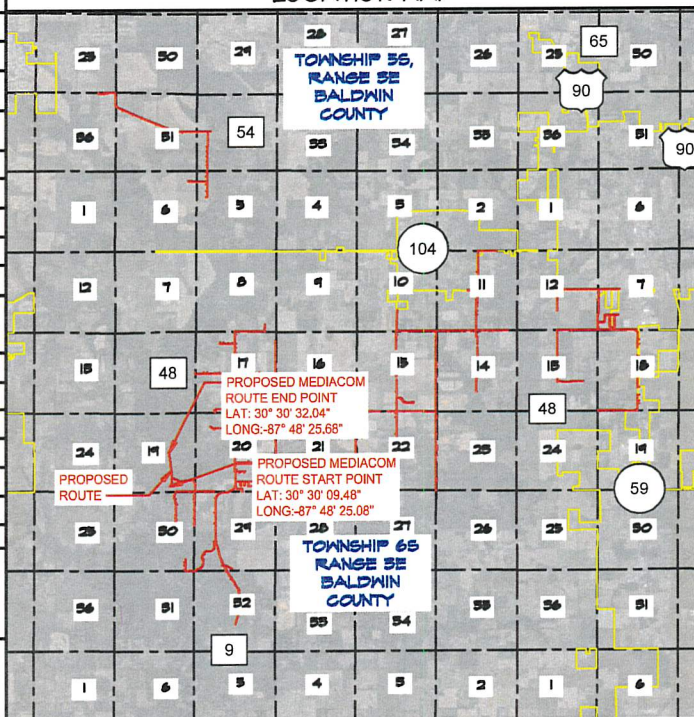

INDEX

SHEET	SHEET TITLE	REV
1 OF 9	TITLE PAGE	A
2 OF 9	NOTES	A
3 OF 9	NOTES & SYMBOLS	A
4 OF 9	OVERVIEW MAP	A
5 TO 6	PLAN & SECTION VIEW - (E RIVER RD. N)	A
7 OF 9	DETAILS	A
8 OF 9	DETAILS	A
9 OF 9	DETAILS	A
-	(MUTCD) TRAFFIC CONTROL	12/23

REV NUMBER	SHEET TITLE	BALDWIN COUNTY UTILITY ROW PERMIT DRAWING SET FOR PROPOSED FIBER OPTIC CABLE INSTALLATION IN THE EX. R.O.W. - ROBERTSON TWP TOWNSHIP 6S, RANGE 3E - BALDWIN COUNTY - AL	CONTRACTOR:	PROVIDER CONTACT:	811	SHEET SCALE	NORTH DIRECTION	Wavelength Services	Mediacom
A	TITLE PAGE	DATE: 02/07/25 DRAWN BY: WAVELENGTH APPROVED: MEDIACOM	INSTALLATION PROPOSED DIRECTIONALLY BORED TYPE: FIBER OPTIC CABLE CONDUIT: 1.5" HDPE	PERMIT REVIEW - 02/07/25	WAVELENGTH SERVICES JEFF PFAFF 634 E BENTON ST MORRIS, IL 60450 (815) 931-5288 jeff@wavelengthservices.net	MEDIACOM BRANT CLOWERS 275 NORMAN DR. VALDOSTA, GA 31601 (229) 244-3852 bclowers@mediacomcc.com	1-800-292-8525		the power to simplify PROJECT NUMBER: N/A

1. THE LOCATIONS OF UTILITY MAINS, STRUCTURES, AND SERVICE CONNECTIONS PLOTTED ON THESE DRAWINGS ARE APPROXIMATE ONLY AND WERE OBTAINED FROM RECORDS MADE AVAILABLE TO THE DESIGN FIRM BY COUNTY OR U.S. ENTITIES. THERE MAY BE OTHER EXISTING UTILITY MAINS, STRUCTURES, AND SERVICE CONNECTIONS NOT KNOWN AND NOT SHOWN ON THIS DRAWING. VERIFICATION OF THE LOCATIONS OF THE UTILITY MAINS, STRUCTURES AND SERVICE CONNECTIONS SHALL BE THE RESPONSIBILITY OF THE CONSTRUCTION CONTRACTOR.
2. SENDING AND RECEIVING PITS SHALL BE RESTORED TO EXISTING CONDITIONS BEFORE CONSTRUCTION. SEED WITH AN APPROVED ALABAMA DOT SEED MIX.
3. PROTECTIVE BARRICADE FENCING SHALL BE IN PLACE AT PITS WHEN WORKERS ARE NOT PRESENT. TRAFFIC CONTROL AND PROTECTION SHALL BE UTILIZED AT ALL TIMES IN CONFORMANCE WITH ALABAMA DEPARTMENT OF TRANSPORTATION STANDARDS.
4. SENDING AND RECEIVING PITS SHALL BE A MAXIMUM OF 4 FEET WIDE BY 4 FEET LONG AND AT A MINIMUM DEPTH OF 4 FEET.
5. FIBER/COAX PLACEMENT AND SLACK COILS PER MEDIACOM STANDARDS.
6. HAND HOLES SHALL BE INSTALLED AT DIRECTION CHANGES OF 45° OR GREATER AND/OR AT MINIMUM DISTANCE OF 800 FEET AND A MAXIMUM OF 1200 FEET.
7. HORIZONTAL BORING SHALL BE AT ROAD INTERSECTIONS, ROAD CROSSINGS, RAILROAD CROSSINGS, CREEK CROSSINGS, SURFACED DRIVEWAYS, AND HEAVY TREE COVER.
8. TRENCHING / DIRECT BURY SHALL BE THE PREFERRED STANDARD INSTALLATION.
9. HORIZONTAL BORINGS SHALL BE 1.5" INCH HDPE DUCT AND TRENCHING/ DIRECT BURY SHALL BE ARMORED CABLE. TYPICAL PLOW INSTALLATION SHALL BE AT A DEPTH OF 36 INCHES UNLESS OTHERWISE SPECIFIED ON A SHEET OF THE CONSTRUCTION PLAN SET.
10. AERIAL INSTALLATION OF UTILITY SERVICES CROSSING D.O.T. ROADWAYS SHALL MAINTAIN A MINIMUM OF 20 FOOT CLEARANCE FROM FINISHED ROADWAY SURFACE.
11. GENERAL INSTALLATION DEPTHS FOR ALL DUCT / CABLE SHALL BE 36" BELOW GRADE. CONTROLLED INTERSECTIONS, CREEKS, RAILROADS, ETC., SHALL BE PER LOCAL JURISDICTIONAL REQUIREMENTS. DUCT / CABLE SHALL BE PLACED AT A MINIMUM DEPTH OF 48" BELOW ROADWAYS. DUCT / CABLE SHALL BE PLACED AT A MINIMUM DEPTH OF 36" BELOW STORM SEWERS, SUBDRAINS, CULVERTS, BEING CROSSED. CROSS DRAINS SHALL BE BORED AT A DEPTH OF 72" BELOW. BOX CULVERTS, BRIDGES, CREEKS AND RIVERS SHALL BE BORED AT A MINIMUM OF 120" (10 FEET) BELOW THE FLOWLINE/ MUDLINE. DUCT / CABLE SHALL BE PLACED AT A MINIMUM DISTANCE OF 36" FROM OTHER UTILITIES, UNLESS OTHERWISE SPECIFIED ON A SHEET OF THE CONSTRUCTION PLAN SET.
12. FIBER/COAX SHALL BE PLACED APPROXIMATELY WITHIN 5 FEET OFF RIGHT-OF-WAY UNLESS OTHERWISE SHOWN IN PLANS.
13. FIBER OPTIC CABLE SHALL BE INSTALLED AT A MINIMUM OF 5 FEET FROM THE BACK OF THE RIGHT-OF-WAY OR WHEN NOT POSSIBLE, SHALL BE PLACED AT THE TOE OF THE BACKSLOPE FOR PAVED ROADWAYS AND SHALL BE LOCATED 12 TO 14 FEET OFF THE CENTERLINE (GRASS SHOULDER) ON GRAVEL / ROCK ROADWAYS.
14. WHEN ROUTING FIBER/COAX LINE OVERHEAD, COORDINATE WITH POWER POLE OWNER FOR ATTACHMENT REQUIREMENTS, ROUTING LOCATION, SPACING FROM EXISTING OVERHEAD UTILITIES AND APPROVAL.
15. HAND DIG AND/OR POTHOLE WHEN CROSSING EXISTING UTILITIES, NEW FIBER/COAX WILL TYPICALLY BE ROUTED UNDER EXISTING UTILITIES. IF EXISTING UTILITIES ARE AT 48" OR GREATER BELOW GRADE, NEW FIBER/COAX WILL BE ROUTED ABOVE, UNLESS AT A ROADWAY THEN REFER TO NOTE 10.
16. MAINTAIN A HORIZONTAL CLEARANCE OF 2 FEET FROM ELECTRICAL UTILITIES AND 1.5 FEET FROM ALL OTHER UTILITIES UNLESS NOTED OTHERWISE.
17. TRAFFIC CONTROL BASED ON DOT STANDARDS / MUTCD SECTION 6 - PFR STANDARD ROAD PLANS
18. ADDITIONAL DOT SPECIFICATIONS, IF APPLICABLE, ARE ATTACHED TO PERMIT SET OR AS SEPARATE EXHIBIT.
19. THE RIGHT-OF-WAY (ROW) LOCATIONS SHOWN ON THE DRAWINGS WERE OBTAINED FROM INFORMATION PROVIDED BY OUTSIDE SOURCES. DIMENSIONS SHOWN ARE BASED ON THE INFORMATION PROVIDED IT IS THE RESPONSIBILITY OF THE CONTRACTOR TO VERIFY ACTUAL RIGHT-OF-WAY (R.O.W) LOCATIONS AND THAT THE "AS CONSTRUCTED ALIGNMENT AND STRUCTURES ARE WITHIN THE RIGHT-OF-WAY (R.O.W)
20. THE CONTRACTOR SHALL COMPLY WITH MEDIACOM POLICIES AND PROCEDURES AND REQUIREMENTS FROM LOCAL PERMITTING AUTHORITIES. THE VARIOUS PERMITS OBTAINED FOR THE PROJECT WILL BE ON FILE IN THE OFFICE OF MEDIACOM AND A COPY SHALL BE AVAILABLE AT THE CONSTRUCTION SITE DURING CONSTRUCTION ACTIVITIES. NO CONSTRUCTION, EXCAVATION OR IMPROVEMENT(S) OF ANY KIND SHALL BEGIN ON THE SURFACE, IN THE SUBSURFACE OR ABOVE THE SURFACE WITHOUT A SIGNED PERMIT FROM THE GOVERNING PERMIT AUTHORITY OR AUTHORITIES.

21. CONTRACTOR AND FINISHED WORK SHALL CONFORM TO THE CURRENT STATEWIDE URBAN DESIGN AND SPECIFICATIONS (SUDAS) PROGRAM, INCLUDING LOCAL GOVERNMENTAL SUPPLEMENTAL SPECIFICATIONS IN EFFECT WITHIN THE APPLICABLE JURISDICTION. AREAS WHERE WORK IS PERFORMED SHALL BE RETURNED TO A CONDITION EQUAL TO OR BETTER THAN THEIR ORIGINAL CONDITION AS DETERMINED BY THE LOCAL JURISDICTION.
22. MISCELLANEOUS STRUCTURES AND OBSTRUCTIONS SUCH AS SIGN POSTS, MAIL BOXES, METER BOXES, ETC., WHEN REMOVED TO EXPEDITE THE WORK, SHALL BE REINSTALLED TO A CONDITION EQUAL TO OR BETTER THAN THEIR ORIGINAL CONDITION.
23. THE CONTRACTOR SHALL BE RESPONSIBLE FOR THE MAINTENANCE OF STREETS AND UTILITIES AFFECTED BY WORK OPERATIONS. DEBRIS SHALL NOT BE PERMITTED TO ACCUMULATE AND PREMISES SHALL BE MAINTAINED IN A NEAT AND WORKMANLIKE CONDITION. A WASTE SITE SHALL BE DESIGNATED FOR THE DISPOSAL OF EXCESS MATERIALS AND DEBRIS.
24. THE CONTRACTOR SHALL TAKE ADEQUATE PRECAUTIONS TO PROTECT EXISTING FACILITIES, SIDEWALKS, CURBS, PAVEMENTS, UTILITIES, FOLIAGE, AND ADJOINING PROPERTY AND STRUCTURES OUTSIDE OF RIGHT-OF-WAY AND TO AVOID DAMAGE THERETO.
25. WHERE HAZARDOUS CONDITIONS EXIST, PROPER SIGNING, FLAGGING, AND BARRICADING SHALL BE PROVIDED AS DIRECTED BY MEDIACOM. SUPPLEMENTAL SIGNS, FLAG PERSON(S), AND BARRICADES SHALL BE PROVIDED BY THE CONTRACTOR. NO TRENCH OR EXCAVATION SITE SHALL BE LEFT UNATTENDED OR OPEN OVERNIGHT.
26. THE CONTRACTOR SHALL COMPLY WITH CURRENT AND APPLICABLE OCCUPATIONAL SAFETY AND HEALTH ADMINISTRATION (OSHA), FEDERAL, U.S., AND LOCAL RULES AND REGULATIONS GOVERNING THE SAFETY OF EMPLOYEES AND MATERIAL DURING THE CONSTRUCTION, INSTALLATION, AND RESTORATIONS ON THIS PROJECT.
27. WHEN PLOWING/TRENCHING FOR PLACEMENT OF DUCT, A MEDIACOM APPROVED MAGNETIC MARKER TAPE SHALL ALSO BE PLACED 18" BELOW EXISTING SURFACE DIRECTLY ABOVE THE CABLE OR DUCT BEING PLACED.
28. THE FOLLOWING SPECIAL PROVISIONS SHALL APPLY TO THE TRAFFIC REGULATIONS DURING THE EXTENT OF THIS PROJECT.
 - A. THERE SHALL BE ADEQUATE VEHICLE AND PEDESTRIAN ACCESS FOR INGRESS AND EGRESS FOR THE PROPERTIES ADJACENT TO THE PROJECT.
 - B. DURING NON-WORKING HOURS THE CONTRACTOR SHALL KEEP THE EXISTING TRAFFIC LANES CLEAR FROM INTERFERENCE, INCLUDING APPROACHES AND INTERSECTIONS.
 - C. IF A LANE BLOCKAGE IS UNAVOIDABLE, THE CONTRACTOR SHALL NOTIFY THE JURISDICTIONAL TRAFFIC ENGINEERING DEPARTMENT, POLICE DEPARTMENT, FIRE DEPARTMENT, AMBULANCE SERVICES, SCHOOL BUS GARAGES, AND OTHER AGENCY OPERATIONS AS APPROPRIATE SO THAT THESE AGENCIES MAY RE-ROUTE THEIR VEHICLES AROUND THE CONSTRUCTION ZONE(S).
28. ALABAMA STATE LAW REQUIRES EXCAVATORS TO NOTIFY ALABAMA ONE-CALL AT LEAST 48 (FORTY-EIGHT) HOURS PRIOR TO ALL EXCAVATIONS (EXCLUDING SATURDAYS, SUNDAYS, AND LEGAL HOLIDAYS). CONTRACTOR MUST CAREFULLY HAND DIG WITHIN THE 24" SAFETY ZONE WHEN EXPOSING UNDERGROUND UTILITIES. ALABAMA ONE-CALL DOES NOT MARK ALL PRIVATE UTILITIES. CONTACTS FOR THIS PROJECT:

TYPICAL HORIZONTAL BORE DESIGN INFORMATION:

1. LENGTH OF BORE RIG TO BE USED FOR INSTALLATION: 19'
2. TYPICAL DRILL ROD LENGTH: 10'.
3. TYPICAL RIG SIDE ENTRY ANGLE: - (OPTIMUM 10-12 DEGREES) (RIGS 10-18 DEGREES.
4. TYPICAL EXIT POINT EXIT ANGLE: OPTIMUM 8 DEGREES
5. DOWN SLOPES: MINIMUM 10 FEET OR ONE DRILL ROD LENGTH
5. UP SLOPES: MINIMUM 10 FEET OR ONE DRILL ROD LENGTH
6. HORIZONTAL: MINIMUM 10 FEET OR ONE DRILL ROD LENGTH
7. TYPICAL RADIUS OF CURVATURES UNLESS NOTED OTHERWISE: IS EQUAL TO (100*DUCT DIAMETER)
8. BORE PITS WITH DEPTHS IN EXCESS OF 4.0' REQUIRE AN OSHA APPROVED EXITING DEVICE TO BE USED FOR WORKING AROUND AND IN THE BORE PITS. PLEASE REFER TO OSHA 29CFR-1926.651 AND 1926.652 INCLUDING BUT NOT LIMITED TO 29CFR-1926.651(c)(2)

REV NUMBER	SHEET TITLE	BALDWIN COUNTY UTILITY ROW PERMIT DRAWING SET FOR PROPOSED FIBER OPTIC CABLE INSTALLATION IN THE EX. R.O.W. - ROBERTSON TWP TOWNSHIP 6S, RANGE 3E - BALDWIN COUNTY - AL		CONTRACTOR: WAVELENGTH SERVICES JEFF PFAFF 834 E BENTON ST MORRIS, IL 60450 (815) 931-5268 jpf@wavelengthservices.net	PROVIDER CONTACT: MEDIACOM BRANT CLOWERS 275 NORMAN DR. VALDOSTA, GA 31601 (229) 244-3852 bdcrowns@mediacom.com		SHEET SCALE	NORTH DIRECTION		 the power to simplify PROJECT NUMBER: N/A
A	NOTES MEDIACOM GENERAL NOTES	DATE: 02/07/25	INSTALLATION: PROPOSED DIRECTIONALLY BORED							
SHEET NUMBER		DRAWN BY: WAVELENGTH	TYPE: FIBER OPTIC CABLE	A. PERMIT REVIEW - 02/07/25						
2 OF 9		APPROVED: MEDIACOM	CONDUIT: 1.5" HDPE	-						

CONSTRUCTION IN RIGHT-OF-WAYS

1. ANY OPEN ROAD ROAD CUT REQUIRES PRIOR APPROVAL OF THE CITY, COUNTY, STATE OR ANY OTHER AGENCY WHICH MAY HAVE JURISDICTION.
2. ALL CONSTRUCTION, MATERIALS AND WORKMANSHIP SHALL BE IN ACCORDANCE WITH THE LOCAL JURISDICTION REQUIREMENTS, SPECIFICATIONS AND STANDARDS.
3. THE CONTRACTOR SHALL INSTALL APPROVED EROSION CONTROL MEASURES AND COMPLY WITH ALL RULES AND REGULATIONS OF THE STATE, COUNTY OR CITY AUTHORITIES REGARDING CLOSING OR RESTRICTING THE USE OF PUBLIC STREETS OR HIGHWAYS. STREETS MUST BE OPENED TO TRAFFIC BY THE END OF THE BUSINESS DAY DURING CONSTRUCTION.
4. CONTRACTOR SHALL INSTALL BLACK DIRT AND PREMIUM TOP SOIL PRIOR TO SEEDING AND FERTILIZING REPAIRED AREAS IF SOD IS NOT INSTALLED. ALSO INSTALL STRAW MAT OR A COCOA MAT OVER THE BLACK DIRT TO PREVENT SURFACE EROSION.
5. CONTRACTOR SHALL MINIMIZE DRIVING ON THE RIGHT-OF-WAY AND UTILIZE LANE CLOSURES WHENEVER POSSIBLE TO MINIMIZE DAMAGE AND NEED FOR RESTORATION.
6. CONTRACTOR SHALL SET VAULT TOPS TO BE LEVEL WITH FINISHED GRADE AND NOT INTERFERE WITH MOWING OPERATIONS OR CREATE TRIPPING HAZARDS.
7. AFTER COMPLETION OF THE NODE INSTALLATION ALL AREA IN EXISTING RIGHT-OF-WAY DISTURBED BY CONSTRUCTION SHALL BE RESTORED EQUAL TO OR BETTER THAN ORIGINAL CONDITION , WHICH MAY INCLUDE THE INSTALLATION OF SOD, AND BE TO THE SATISFACTION OF THE PERMITTING AGENCY WITHIN A 7-DAY PERIOD OR LESS IF DICTATED BY THE LOCAL JURISDICTION.
8. STREET OR HIGHWAY RESTORATION SHALL BE DONE AS PER LOCAL OR STATE AGENCY HAVING JURISDICTION.
9. THE CONTRACTOR SHALL COMPLY WITH ALL RULES AND REGULATIONS OF THE STATE, COUNTY OR CITY AUTHORITIES REGARDING CLOSING OR RESTRICTING THE USE OF PUBLIC STREETS OR HIGHWAYS. STREETS MUST BE OPENED TO TRAFFIC BY THE END OF THE BUSINESS DAY.

	OVERLASHED SERVICE		4x4 TEMPORARY BORE PIT / POTHOLE AREA
	PRIVATE FEED NOT ON PUBLIC R.O.W.		MEDIACOM PEDESTAL
	FIBER OPTIC CABLE INSTALL		2'x3' MEDIACOM HANDHOLE
			INCREASED IN BORE DEPTH
	UNDERGROUND ELECTRIC		NEW RISER
	UNDERGROUND FIBER OPTIC		EXISTING RISER
	GAS MAIN / SERVICE		2x3 UTILITY VAULT
	UNDERGROUND TELEPHONE		11x17 UTILITY VAULT
	SANITARY SEWER		WOOD UTILITY POLE w/ TRANSFORMER
	STORM SEWER		WOOD UTILITY POLE
	WATER MAIN/SERVICE		STREET LIGHT POLE
	OVERHEAD ELECTRIC		PAD MOUNT TRANSFORMER
	OVERHEAD TELEPHONE		RAILROAD TRACK SIGNAL EQUIPMENT / ROAD CROSSING SIGNAL w/ ARM
	OVERHEAD ELECTRIC & TELCO		
	EXISTING PAVEMENT		
	RIGHT-OF-WAY		
	PROPERTY/ LOT LINE		
	P.U.E. / EASEMENT		
	EXISTING FENCE		
	SECTION LINE		
	DENSE TREE LINE		
	OVERHEAD CABLE TV		
	OVERHEAD FIBER		
	UNDERGROUND CABLE TV PROVIDER SERVICE		
	UNDERGROUND FIBER PROVIDER SERVICE		
	EXISTING MANHOLE		
	FIRE HYDRANT		
	EXISTING PEDESTAL		

REV NUMBER	SHEET TITLE	BALDWIN COUNTY UTILITY ROW PERMIT DRAWING SET FOR PROPOSED FIBER OPTIC CABLE INSTALLATION IN THE E.X. R.O.W. - ROBERTSON TWP TOWNSHIP 6S, RANGE 3E - BALDWIN COUNTY - AL				CONTRACTOR:	PROVIDER CONTACT:		SHEET SCALE	NORTH DIRECTION		 the power to simplify PROJECT NUMBER: N/A
A	NOTES & SYMBOLS	DATE: 02/07/25	INSTALLATION: PROPOSED DIRECTIONALLY BORED		WAVELENGTH SERVICES JEFF PFAFF 834 E BENTON ST MORRIS, IL 60450 (815) 931-5288 jeff@wavelengthservices.net	MEDIACOM BRANT CLOWERS 275 NORMAN DR. VALDOSTA, GA 31601 (229) 244-3852 bcowers@mediacom.com						
SHEET NUMBER		DRAWN BY: WAVELENGTH	TYPE: FIBER OPTIC CABLE	A PERMIT REVIEW - 02/07/25								
3 OF 9		APPROVED: MEDIACOM	CONDUIT: 1.5" HDPE									

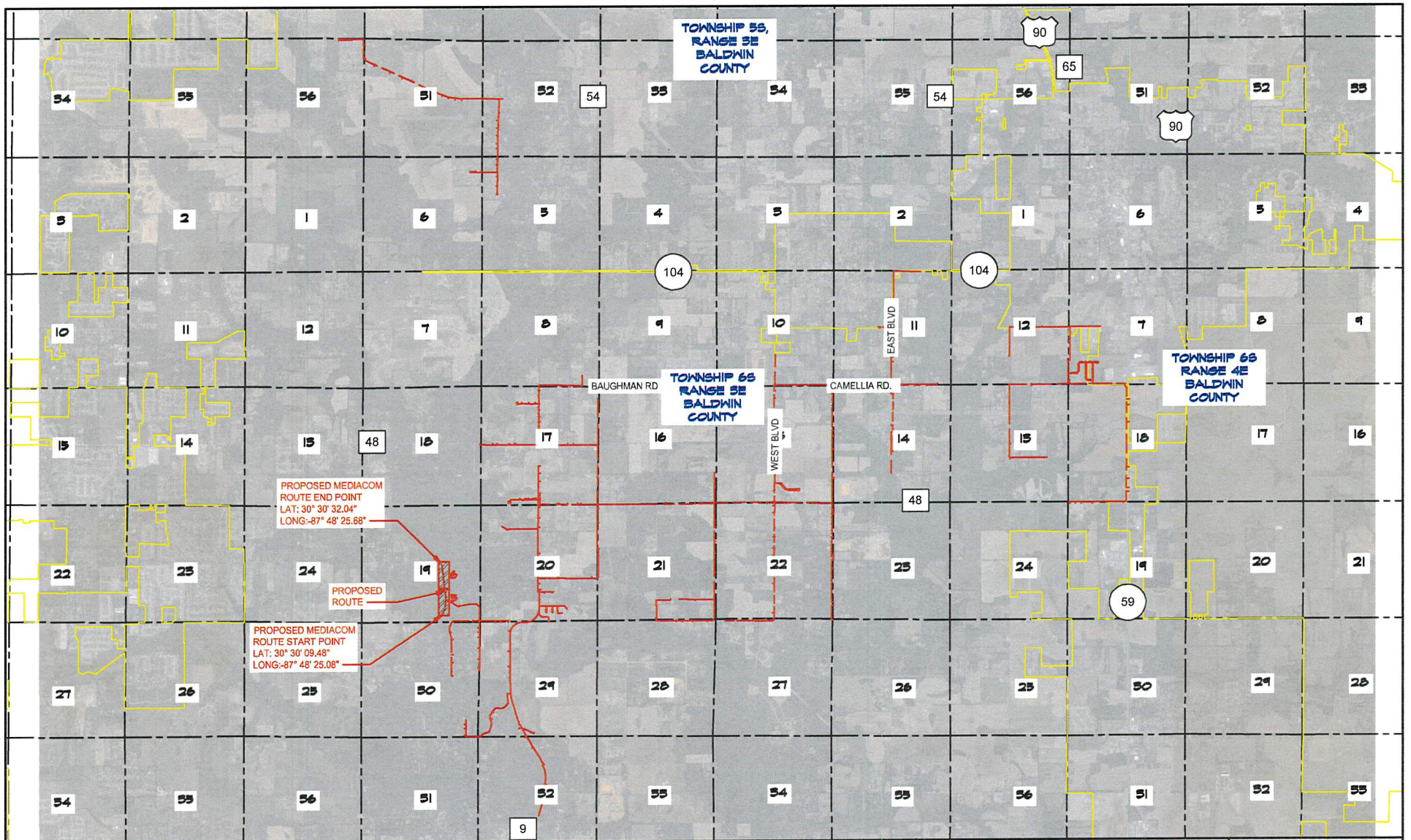

REV NUMBER	SHEET TITLE	BALDWIN COUNTY UTILITY ROW PERMIT DRAWING SET FOR PROPOSED FIBER OPTIC CABLE INSTALLATION IN THE EX. R.O.W. - ROBERTSON TWP TOWNSHIP 6S, RANGE 3E - BALDWIN COUNTY - AL				CONTRACTOR:	PROVIDER CONTACT:	SHEET SCALE	NORTH DIRECTION	 	
A	OVERVIEW MAP	DATE: 02/07/25	INSTALLATION: PROPOSED DIRECTIONALLY BORED	CONTRACTOR:	PROVIDER CONTACT:	WAVELENGTH SERVICES JEFF PFAFF 834 E BENTON ST MORRIS, IL 60450 (815) 931-5288 jeff@wavelengthservices.net	MEDIACOM BRANT CLOWERS 275 NORMAN DR. VALDOSTA, GA 31601 (229) 244-3852 bdclowers@mediacom.com	1"=400'		 	
SHEET NUMBER		DRAWN BY: WAVELENGTH	TYPE: FIBER OPTIC CABLE	PERMIT REVIEW - 02/07/25							
4 OF 9		APPROVED: MEDIACOM	CONDUIT: 1.5" HDPE								

GENERAL PLAN NOTES:

- CONTRACTOR SHALL CALL IN A UTILITY LOCATE 72 HOURS PRIOR TO BEGINNING CONSTRUCTION AND VERIFY DEPTH OF EXISTING UTILITIES WITHIN THE ROUTE PRIOR TO INSTALLATION. ANY UTILITIES FOUND TO BE WITHIN THE PROPOSED ROUTE SHALL BE NOTED AND SENT TO THE DESIGN FIRM AND DOT FOR RECORDS.
- ROADWAY RIGHT-OF-WAY DERIVED FROM HIGHWAY PLANS, OBTAINED FROM ALABAMA DOT RECORDS FOR BALDWIN COUNTY, AL AND GIS DEPARTMENT. ACTUAL ROAD STATIONING MAY VARY, COORDINATE w/DOT FOR ACTUAL STATIONING.
- FIBER OPTIC CABLE SHALL BE INSTALLED AT A DEPTH OF 3 FEET BELOW GRADE, UNLESS BEDROCK IS ENCOUNTERED, OTHERWISE NOTED.
 - BORE MUST BE A MINIMUM OF 120" BELOW THE FLOWLINE/MIDLINE OF CREEKS, STREAMS, & RIVERS
 - BORE MUST BE A MINIMUM OF 120" BELOW THE BOX CULVERTS AND BRIDGES
 - BORE MUST BE 72" BELOW CROSS DRAINS
 - BORE MUST BE PLACED 48" BELOW ROADWAYS & MUST BE INSTALLED PERPENDICULAR TO THE ROADWAY WITHIN THE RIGHT-OF-WAY.
- LOCATION FOR FIBER OPTIC CABLE, VAULTS AND PEDESTALS IS TO THE BACK OF THE RIGHT-OF-WAY. VAULTS AND PEDESTALS ARE NOT ALLOWED IN CURVES OF ROADWAYS.
- FIBER OPTIC CABLE SHALL BE INSTALLED AT A MINIMUM OF 5 FEET FROM THE BACK OF THE RIGHT-OF-WAY OR WHEN NOT POSSIBLE, SHALL BE PLACED AT THE TOE OF THE BACKSLOPE FOR PAVED ROADWAYS AND SHALL BE LOCATED 12 TO 14 FEET OFF THE CENTERLINE (GRASS SHOULDER) ON GRAVEL / ROCK ROADWAYS.
- BORE ALL SURFACED DRIVEWAYS UNLESS GRANTED WITH WRITTEN PERMISSION BY PROPERTY OWNER.
- AVOID BORE PITS ON ROADBEDS. WHEN NECESSARY, COMPACTED SOIL BACKFILL TO ONE FOOT OF SURFACE. TOP FOOT SHALL BE COMPACTED CLASS A ROADSTONE AS SPECIFIED BY THE COUNTY.

SHOWN ON PERMIT SET FOR HEIDELBERG LN FROM THIS POINT

PROPOSED MEDIACOM 1.5" HDPE CONDUIT WITH FIBER OPTIC CABLE TRENCHED, PLOWED, SPLIT AND/OR DIRECTIONALLY BORED ON WITHIN BALDWIN COUNTY R.O.W. AT A MIN. OF 36" BELOW GRADE U.N.O.

ROAD CROSSING BORE @ 48" BELOW ROADWAY

PROPOSED FIBER ROUTE START POINT IN RIGHT-OF-WAY

SPEED LIMIT 25

SECTION 19
TOWNSHIP 5S, RANGE 3E
BALDWIN COUNTY
ROBERTSON TWP

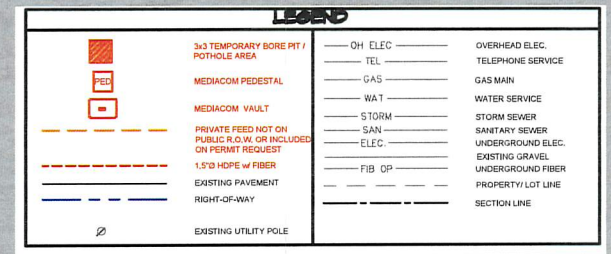

PLAN VIEW - E RIVER RD. N

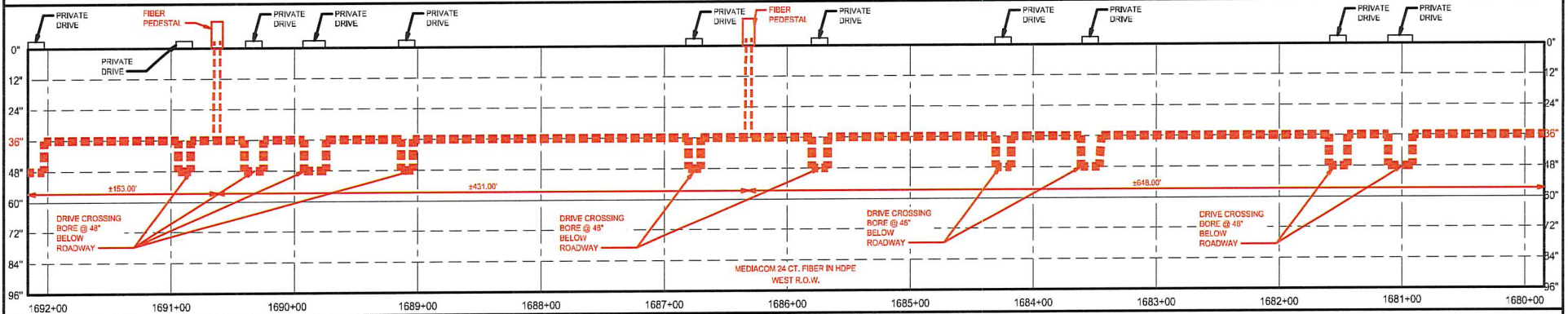

SECTION VIEW - E RIVER RD. N

REV NUMBER	SHEET TITLE	BALDWIN COUNTY COUNTY UTILITY ROW PERMIT DRAWING SET FOR PROPOSED FIBER OPTIC CABLE ROUTED IN EX. COUNTY R.O.W. TOWNSHIP 5S - RANGE 3E - ROBERTSON TWP TWSP - BALDWIN COUNTY - AL	CONTRACTOR:	PROVIDER CONTACT:	SHEET SCALE	NORTH DIRECTION	Wavelength Services	Mediacom
A	PLAN VIEW	DATE: 02/07/25 DRAWN BY: WAVELENGTH APPROVED: MEDIACOM	WAVELENGTH SERVICES JEFF PFAFF 834 E BENTON ST MORRIS, IL 60450 (815) 501-5268 jeff@wavelengthservices.net	MEDIACOM BRANT CLOWERS 275 NORMAN DR VALDOSTA, GA 31601 (229) 244-3852 bdclowers@mediacom.com	1"=50'			
5 OF 9		INSTALLATION PROPOSED DIRECTIONALLY BORED TYPE: FIBER OPTIC CABLE CONDUIT: 1.5" HDPE						the power to simplify PROJECT NUMBER: N/A

GENERAL PLAN NOTES:

- CONTRACTOR SHALL CALL IN A UTILITY LOCATE 72 HOURS PRIOR TO BEGINNING CONSTRUCTION AND VERIFY DEPTH OF EXISTING UTILITIES WITHIN THE ROUTE PRIOR TO INSTALLATION. ANY UTILITIES FOUND TO BE WITHIN THE PROPOSED ROUTE SHALL BE NOTED AND SENT TO THE DESIGN FIRM AND DOT FOR RECORDS.
- ROADWAY RIGHT-OF-WAY DERIVED FROM HIGHWAY PLANS, OBTAINED FROM ALABAMA DOT RECORDS FOR BALDWIN COUNTY, AL AND GIS DEPARTMENT. ACTUAL ROAD STATIONING MAY VARY. COORDINATE W/ DOT FOR ACTUAL STATIONING.
- FIBER OPTIC CABLE SHALL BE INSTALLED AT A DEPTH OF 3 FEET BELOW GRADE. UNLESS BEDROCK IS ENCOUNTERED, OTHERWISE NOTED.
 - BORE MUST BE A MINIMUM OF 120" BELOW THE FLOWLINE/ADLINE OF CREEKS, STREAMS, & RIVERS
 - BORE MUST BE A MINIMUM OF 120" BELOW THE BOX CULVERTS AND BRIDGES
 - BORE MUST BE 72" BELOW CROSS DRAINS
 - BORE MUST BE PLACED 48" BELOW ROADWAYS & MUST BE INSTALLED PERPENDICULAR TO THE ROADWAY WITHIN THE RIGHT-OF-WAY.
- LOCATION FOR FIBER OPTIC CABLE, VAULTS AND PEDESTALS IS TO THE BACK OF THE RIGHT-OF-WAY. VAULTS AND PEDESTALS ARE NOT ALLOWED IN CURVES OF ROADWAYS.
- FIBER OPTIC CABLE SHALL BE INSTALLED AT A MINIMUM OF 5 FEET FROM THE BACK OF THE RIGHT-OF-WAY OR WHEN NOT POSSIBLE, SHALL BE PLACED AT THE TOE OF THE BACKSLOPE FOR PAVED ROADWAYS AND SHALL BE LOCATED 12 TO 14 FEET OFF THE CENTERLINE (GRASS SHOULDER) ON GRAVEL / ROCK ROADWAYS.
- BORE ALL SURFACED DRIVEWAYS UNLESS GRANTED WITH WRITTEN PERMISSION BY PROPERTY OWNER.
- AVOID BORE PITS ON ROADBEDS. WHEN NECESSARY, COMPACTED SOIL BACKFILL TO ONE FOOT OF SURFACE. TOP FOOT SHALL BE COMPACTED CLASS A ROADSTONE AS SPECIFIED BY THE COUNTY.

SECTION 14
TOWNSHIP 66, RANGE 3E
BALDWIN COUNTY
ROBERTSON TWP

SPEED
LIMIT
25

LEGEND	
	3/4" TEMPORARY BORE PIT / POTHOLE AREA
	MEDIACOM PEDESTAL
	MEDIACOM VAULT
	PRIVATE FIBER NOT ON PUBLIC R.O.W. OR INCLUDED ON PERMIT REQUEST
	1.5" HDPE w/ FIBER
	EXISTING PAVEMENT
	RIGHT-OF-WAY
	EXISTING UTILITY POLE
	OH ELEC
	TEL
	CAS
	WAT
	STORM
	SAN
	ELEC
	FIB OP
	OVERHEAD ELEC
	TELEPHONE SERVICE
	GAS MAIN
	WATER SERVICE
	STORM SEWER
	SANITARY SEWER
	UNDERGROUND ELEC
	EXISTING GRAVEL
	UNDERGROUND FIBER
	PROPERTY LOT LINE
	SECTION LINE

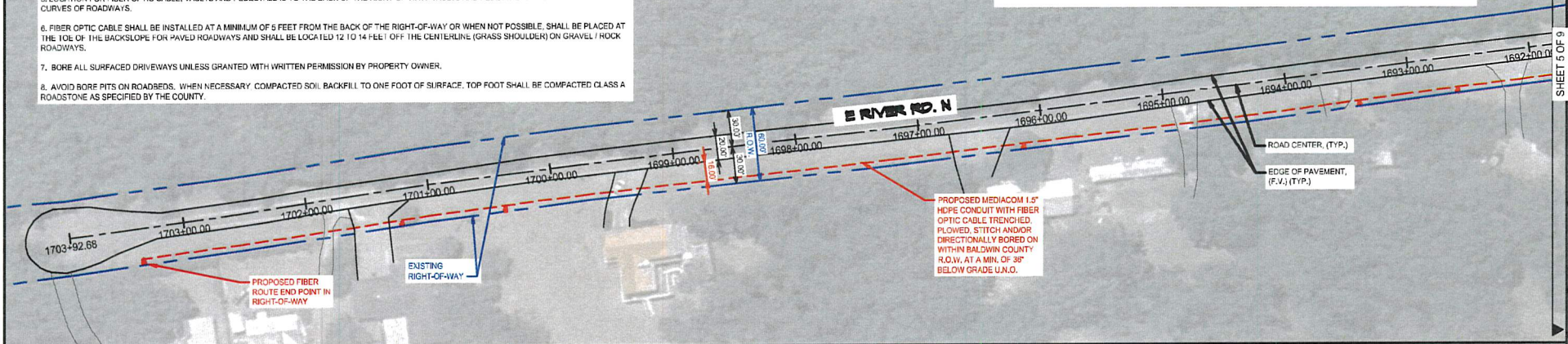

PLAN VIEW - E RIVER RD. N

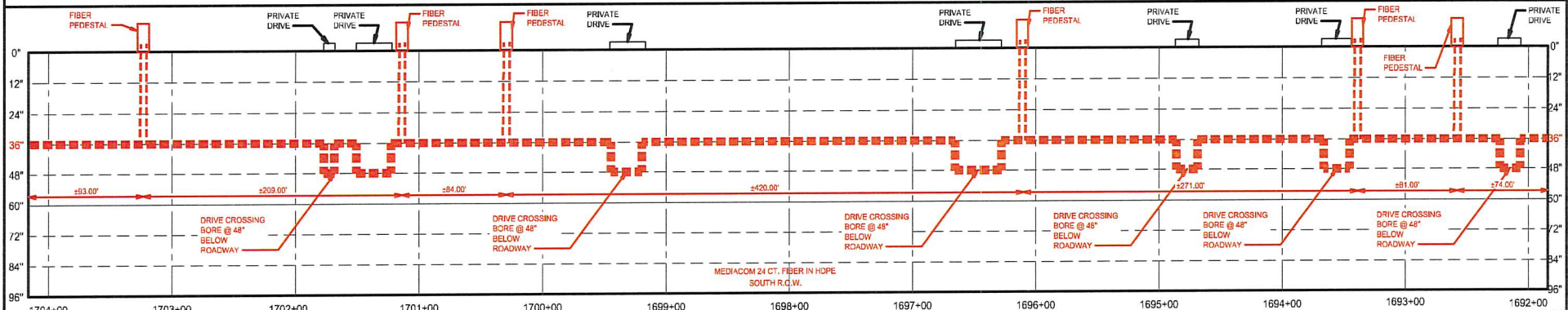

SECTION VIEW - E RIVER RD. N

REV NUMBER	SHEET TITLE	BALDWIN COUNTY COUNTY UTILITY ROW PERMIT DRAWING SET FOR PROPOSED FIBER OPTIC CABLE ROUTED IN EX. COUNTY R.O.W. TOWNSHIP 66, RANGE 3E - ROBERTSON TWP TWP - BALDWIN COUNTY - AL	CONTRACTOR:	PROVIDER CONTACT:	SHEET SCALE	NORTH DIRECTION	Wavelength Services	Mediacom
A	PLAN VIEW	DATE: 02/07/25	WAVELENGTH SERVICES	MEDIACOM	1"=80'			
SHEET NUMBER		INSTALLATION: PROPOSED DIRECTIONALLY BORED	JEFF PFAFF	BRANT CLOWERS				
6 OF 9		DRAWN BY: WAVELENGTH	834 E BENTON ST	275 NORMAN DR.				
		APPROVED: MEDIACOM	MORRIS, IL 60450	VALDOSTA, GA 31801				
			(815) 931-5288	(229) 244-3852				
			jeff@wavelengthservices.net	bdowers@mediacom.com				
				1-800-292-8525				

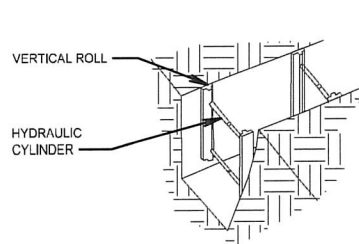

VERTICAL ALUMINUM HYDRAULIC SHORING (SPOT BRACING)

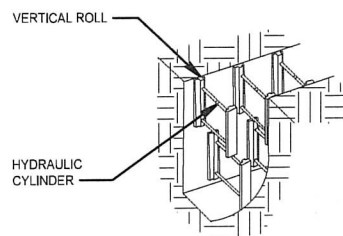

VERTICAL ALUMINUM HYDRAULIC SHORING (STACKED)

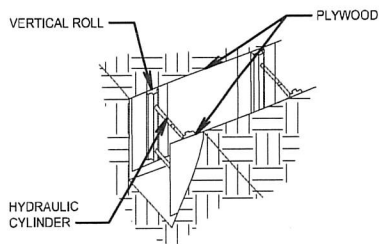

VERTICAL ALUMINUM HYDRAULIC SHORING (WITH PLYWOOD)

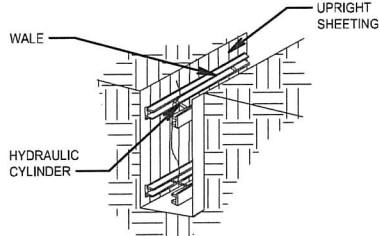

ALUMINUM HYDRAULIC SHORING WATER SYSTEM (TYPICAL)

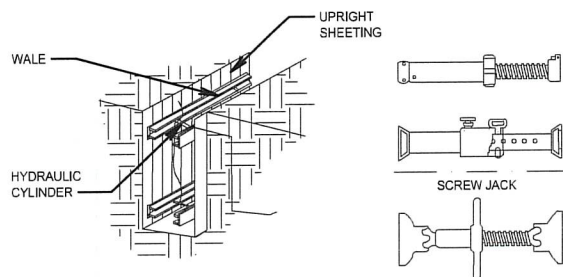

TYPICAL SHORING DETAILS

SCALE: N.T.S.

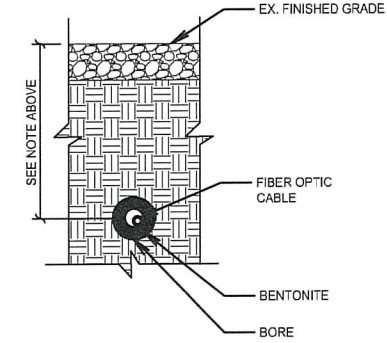
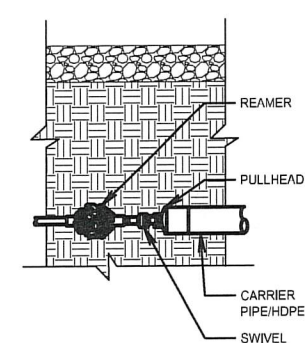
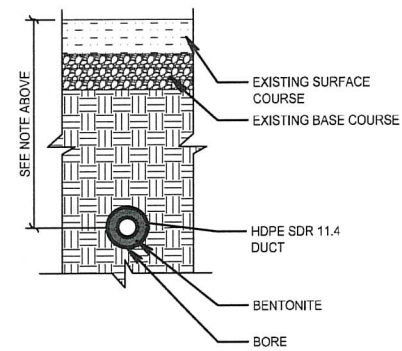
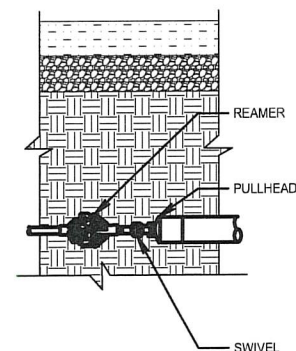

NOTE:

DUCT / CABLE SHALL BE PLACED AT A MINIMUM DEPTH 36" BELOW GRADE WITHIN THE LIMITS OF THE RIGHT-OF-WAY. INSTALL DUCT AT 48" BELOW ROADWAYS AND DITCHLINES UNLESS OTHERWISE SPECIFIED ON A SHEET OF THE CONSTRUCTION PLAN SET. THE GENERAL INSTALLATION DEPTH FOR DUCT / CABLE SHALL BE PLACED AT A MINIMUM DEPTH OF 24" BELOW STORM SEWERS, SUBDRAINS, CULVERTS, AND/OR WATERWAYS BEING CROSSED. DUCT / CABLE SHALL BE PLACED AT A MINIMUM DISTANCE OF 24" FROM OTHER UTILITIES, UNLESS OTHERWISE SPECIFIED ON A SHEET OF THE CONSTRUCTION PLAN SET.



BORE HEAD DETAILS

SCALE: N.T.S.

REV NUMBER	SHEET TITLE	BALDWIN COUNTY UTILITY ROW PERMIT DRAWING SET FOR PROPOSED FIBER OPTIC CABLE INSTALLATION IN THE EX. R.O.W. - ROBERTSON TWP TOWNSHIP 6S, RANGE 3E - BALDWIN COUNTY - AL				CONTRACTOR:	PROVIDER CONTACT:	811	SHEET SCALE	NORTH DIRECTION	  the power to simplify PROJECT NUMBER: N/A
A	DETAILS SHORING DETAILS & TYPICAL BORE HEAD DETAIL	DATE: 02/07/25	INSTALLATION: PROPOSED DIRECTIONALLY BORED			WAVELENGTH SERVICES JEFF PFAFF	MEDIACOM BRANT CLOWERS 275 NORMAN DR. VALDOSTA, GA 31601 (229) 244-3852				
SHEET NUMBER		DRAWN BY: WAVELENGTH	TYPE: FIBER OPTIC CABLE	A	PERMIT REVIEW - 02/07/25	834 E BENTON ST MORRIS, IL 60450 (815) 931-5208 jeff@wavelengthservices.net	bedowers@mmediacom.com				
7 OF 9		APPROVED: MEDIACOM	CONDUIT: 1.5" HDPE	-							

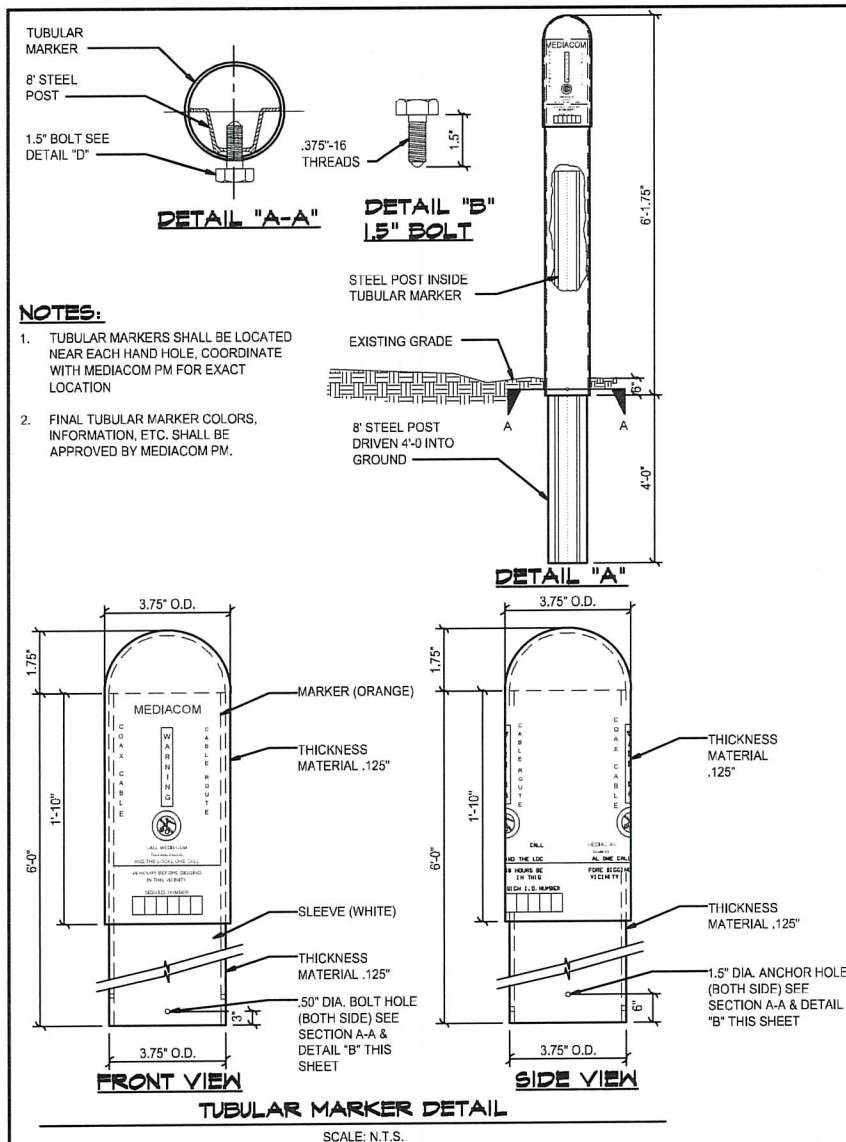

Grade Level Box BULK ④ Series

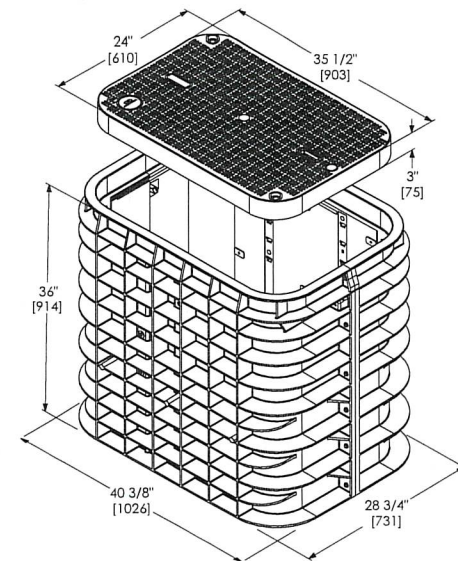
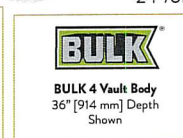

BODY SPECIFICATIONS

Cover Weight	50 lbs	[23 kg]
Pit Weight	82 lbs	[37 kg]
Assembled Weight	132 lbs	[60 kg]

TESTING CRITERIA

- Covers meet or exceed:
- EST 3 Million Cycles
 - Telcordia GR-902-CORE
 - Western Underground Committee Guide 3.6
 - ANSI/SCTE 77 2013-TIER 22
 - EN124 Class A15/B125

- Bodies meet or exceed:
- Telcordia GR-902-CORE
 - Western Underground Committee Guide 3.6
 - ANSI/SCTE 77 2013-TIER 22
 - EN124 Class A15/B125/C250
 - ASTM-457
 - AASHTO M-306 (H-20/25)
 - A53996-Class B/C

TYPICAL UTILITY VAULT

SCALE: N.T.S.

REV NUMBER	SHEET TITLE	BALDWIN COUNTY UTILITY ROW PERMIT DRAWING SET FOR PROPOSED FIBER OPTIC CABLE INSTALLATION IN THE EX. R.O.W. - ROBERTSON TWP TOWNSHIP 6S, RANGE 3E - BALDWIN COUNTY - AL
A	DETAILS TUBE MARKER & VAULT DETAIL	
SHEET NUMBER		
9 OF 9		

CONTRACTOR:	PROVIDER CONTACT:
WAVELENGTH SERVICES	MEDIACOM
JEFF PFAFF	BRANT CLOVERS
834 E BENTON ST	275 NORMAN DR.
MORRIS, IL 60450	VALDOSTA, GA 31601
(815) 931-5288	(229) 244-3852
jeff@wavelengthservices.net	bdowers@mediacom.com
	1-800-292-8525

SHEET SCALE	NORTH DIRECTION

