

N POPLAR ST (60' R.O.W.)

N JUNIPER ST (70' R.O.W.)

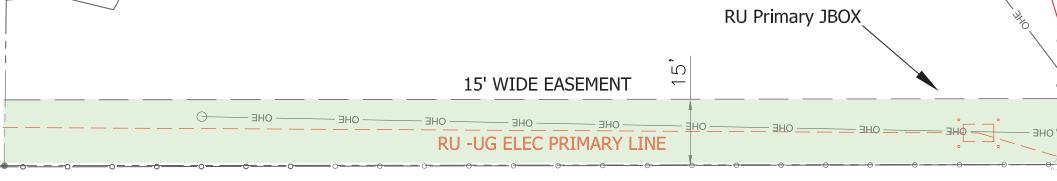
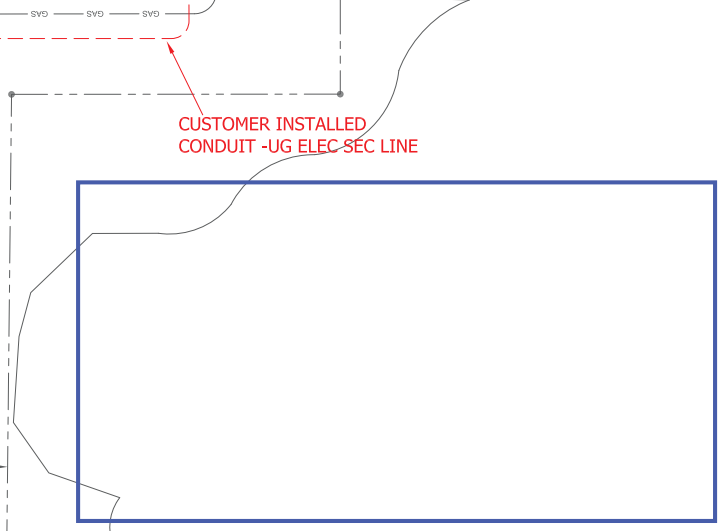
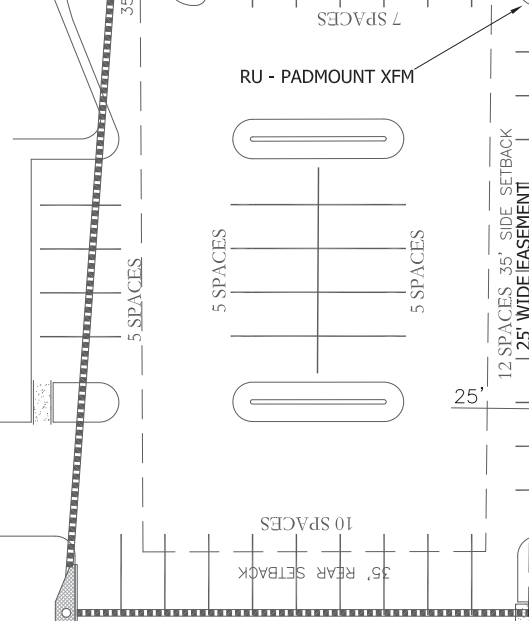
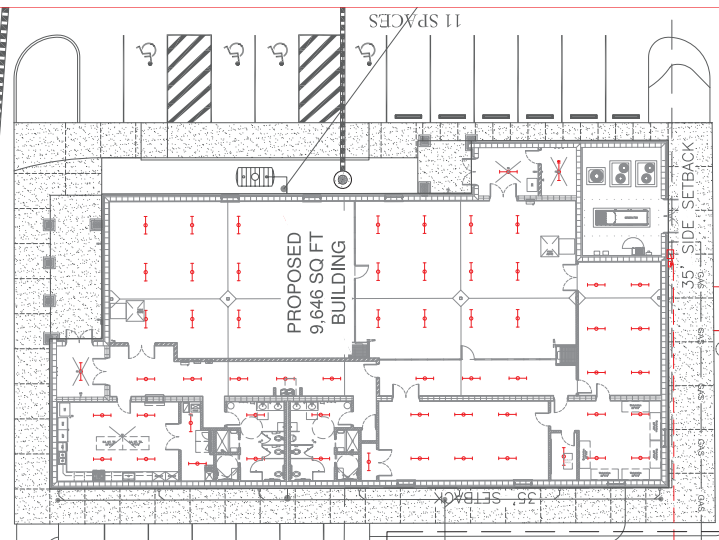

BUILDING MAINTENANCE / BRATS BUILDING (NOT TO SALE)

EXISTING UTILITY POLE



82.28'

82.29'

82.36'

82.28'

SSMH RIM

INV#71.9

INV#71.9

(CA0085LS #4) (ILLEGIBLE 0.09'(W) CRF CRF

CRF (CA0512LS #4)