

MAYOR
Charles H. Murphy

COUNCIL MEMBERS:
Joe M. Kitchens
Paul Hollingsworth
Russell Johnson
Sue Cooper
Ruthie Campbell

CHIEF FINANCIAL OFFICER
Lewis Shealy

CITY CLERK
Shannon J. Burkett

CITY OF ROBERTSDALE



*The Hub
of Baldwin County*

City Hall	251-947-8900
City Clerk	251-947-8920
Court Clerk	251-947-8910
Public Works	251-947-8950
Police Dept.	251-947-2222
Fax	251-947-2619
TDD#	251-947-2122

P. O. Box 429
Robertsdale, AL 36567

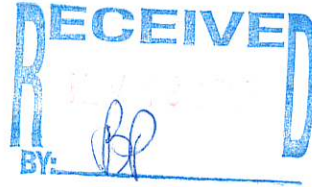

November 15, 2022

To Whom It May Concern:

I have been instructed to provide you with a copy of any annexation ordinances adopted by the City Council of the City of Robertsdale.

Ordinance Number 014-2022 was adopted November 7, 2022.

Should you have any questions, please contact me at shannonburkett@robertsdale.org or (251)947-8920.

Respectfully,

Shannon J. Burkett, CMC/CMRO
City Clerk

ORDINANCE NO. 014-2022

BE IT ORDAINED BY THE CITY COUNCIL OF THE CITY OF ROBERTSDALE, ALABAMA, AS FOLLOWS:

WHEREAS, the City Council of the City of Robertsdale, Alabama has received a petition of annexation from Edward Morgan, for the property located at 19055 Huguen Street, as a R-1 zone, and

WHEREAS, the Planning Commission of the City of Robertsdale has reviewed the proposed annexation of said petition and has recommended the Council proceed with the annexation, and

WHEREAS, the property being considered for annexations is contiguous with the current city limits, and

WHEREAS, the following is a legal description of the property:

Commence at the Southwest corner of the West half of Northwest Quarter, Section 32, Township 5 South, Range 4 East, Baldwin County, Alabama; thence run East 40.00 feet to a point; thence North 00°50'05" East, 20.00 feet to a rebar at the intersection of the north right-of-way of Huguen Street and the east right-of-way of College Avenue; thence along the north right-of-way of Huguen Street, North 89°31'57" East, 189.84 feet to the point of beginning; thence North 00°06'25" East, 165.52 feet to a rebar; thence North 89°55'05" East, 116.69 feet to a rebar; thence South 00°21'56" West, 164.89 feet to a rebar on the north right-of-way of Huguen Street; thence along said north right-of-way, South 89°36'13" West, 115.95 feet to the point of beginning.

BE IT FURTHER ORDAINED THAT THE OFFICIAL ZONING MAP, AS AMENDED, BE FURTHER AMENDED TO REFLECT THIS CHANGE.

Adopted and approved by the City Council of the City of Robertsdale, Alabama, on this 7th day of November, 2022.

ATTEST:

CITY CLERK

MAYOR

CERTIFICATION:

I, Shannon Burkett, as City Clerk of the City of Robertsdale, Alabama, hereby certify that the above and foregoing copy of 1 (one) Ordinance Number 014-2022 is a true and correct copy of such Ordinance that was duly adopted by the City Council of the City of Robertsdale on the 7th day of November, 2022, as same appears in the official records of said City.



SUBJECT PROPERTY

7.5 Ac

1 inch = 150 feet

MORGAN ANNEXATION

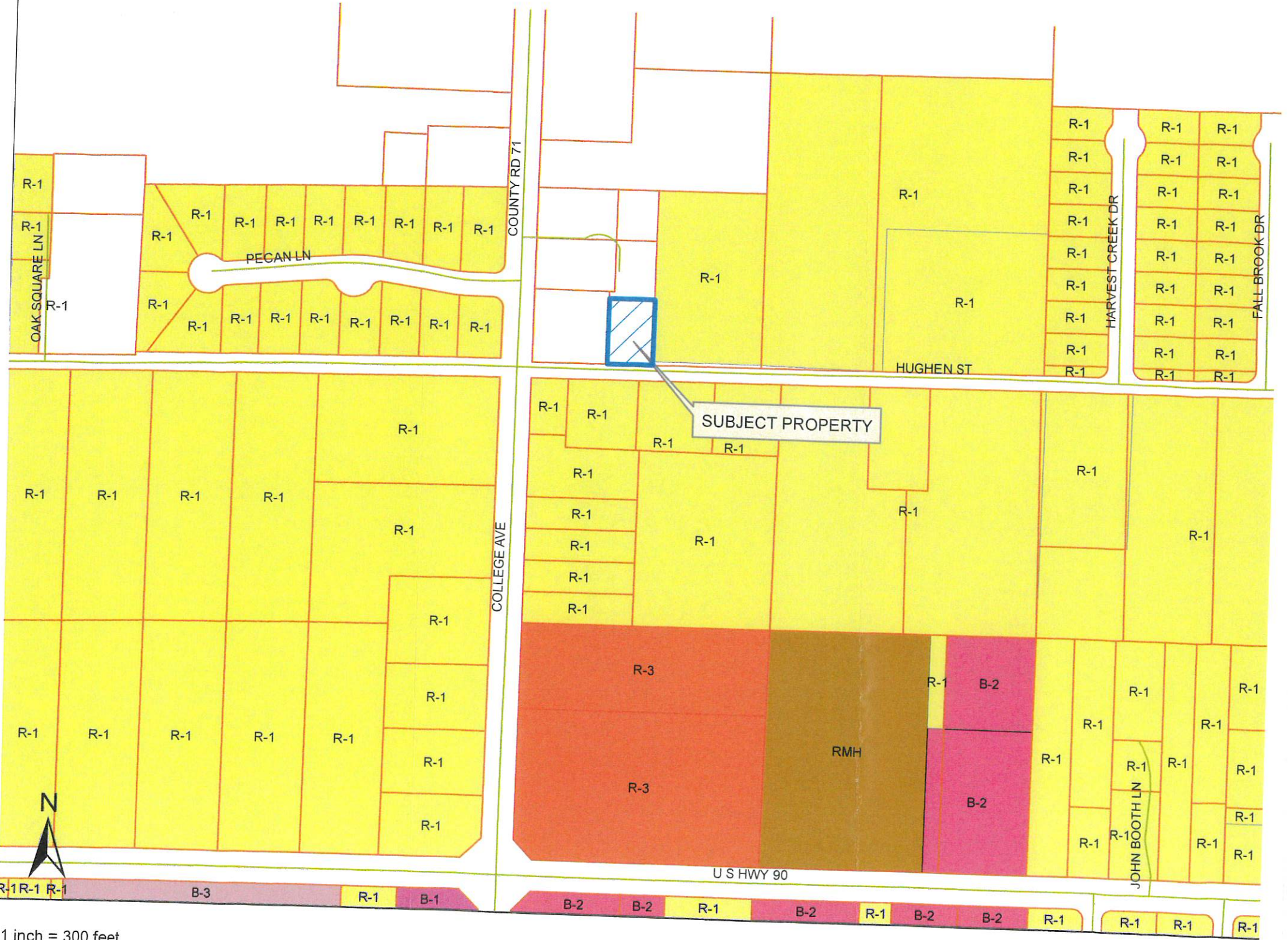

1 inch = 300 feet

MORGAN ANNEXATION