

1 ROOF PLAN  
SCALE: 1/64"=1'0"

SCOPE OF WORK ROOF RESTORATION:

LIQUID MEMBRANE ROOF RESTORATION SYSTEM - ALL  
ROOFTOP SINGLE PLY MEMBRANE ROOF AND FLASHINGS.

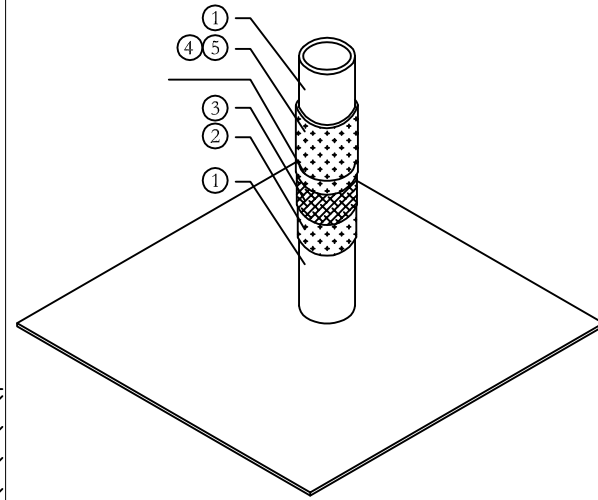

A-1 LIQUID FLASHING REINFORCEMENT; PIPE SUPPORT  
1 N.T.S.

- 1 GRIND/SCRAPE OFF ALL COATINGS & SEALANTS FROM METAL PIPE & MEMBRANE, MASK TARGET AREA ON PIPE & MEMBRANE WITH TAPE, AND CLEAN WITH ISOPROPYL ALCOHOL
- 2 APPLY 32 WET MIL BASE COAT OF LIQUID FLASHING COATING OVER MASKED AREA
- 3 EMBED POLYESTER INTO BASE COAT.
- 4 APPLY 32 WET MIL TOP COAT OF LIQUID FLASHING COATING OVER POLYESTER EXTENDING 2" PAST THE SCRIM IN ALL DIRECTIONS
- 5 APPLY TWO COATS REFLECTIVE SURFACING AFTER 15-30 DAYS CURE

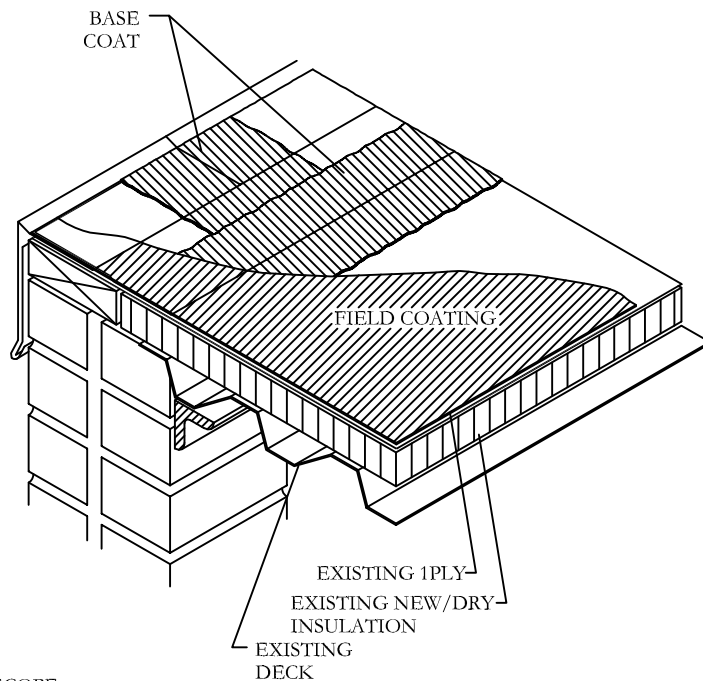

A-2 LIQUID APPLIED MEMBRANE AT EDGE  
2 N.T.S.

- SCOPE
1. METAL EDGE JOINTS AND MEMBRANE LAPS REINFORCED W/ BASE COAT.
  2. FIELD COATING APPLIED OVER ENTIRE ROOF SURFACE.

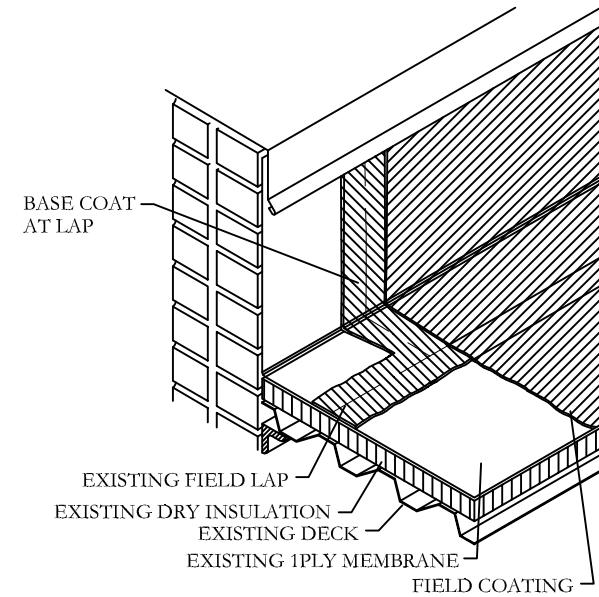

- NOTES:
1. BASE COAT: TWO (2) GALLONS/SQUARE BASE COAT, ALLOW 48 HOUR CURE.
  2. TOP COAT: FIELD COATING OVER BASE COAT AT 2 GALLONS/SQUARE.

A-3 FLASHING REINFORCEMENT  
3 N.T.S.

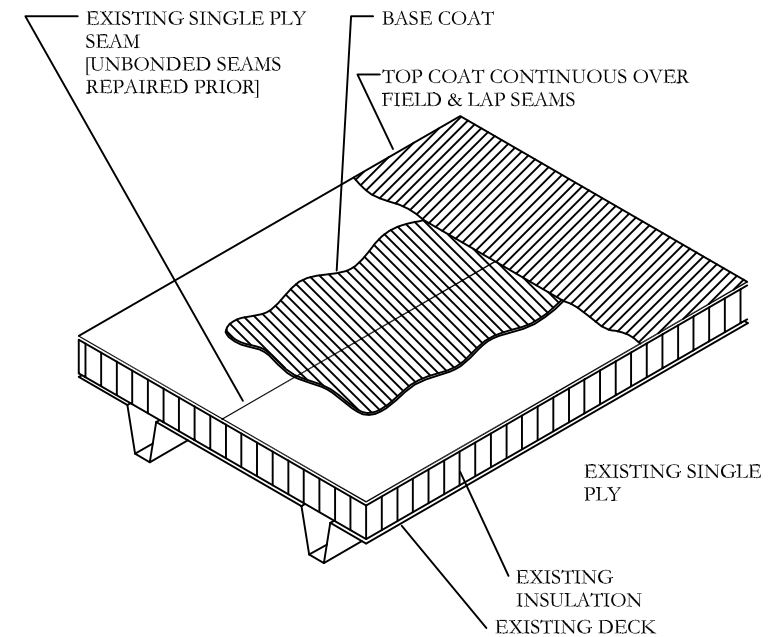

- NOTES:
1. LAP SEAMS: BASE COAT AT 2.0 GAL/SQ, 8" WIDE OVER THE SEAM. ALLOW 24 HOUR CURE.
  2. FIELD & LAP SEAMS: TOP COAT AT 2 GAL/SQ.

A-4 LIQUID MEMBRANE AT FIELD AND LAP SEAMS  
4 N.T.S.

BALDWIN COUNTY JAIL  
ADMINISTRATION BUILDING  
BAY MINETTE, ALABAMA 36507

DRAWN  
P.J.  
CHECKED  
T.T.  
DATE  
10/04/2018  
SCALE  
1/64"=1'0"

SHEET

A-1

1-OF-4 SHEETS