

1 ROOF PLAN
SCALE: 1/32"=1'0"

SCOPE OF WORK ROOF RESTORATION:

LIQUID MEMBRANE ROOF SYSTEM - ALL ROOFTOP SINGLE PLY MEMBRANE ROOF AND FLASHINGS.

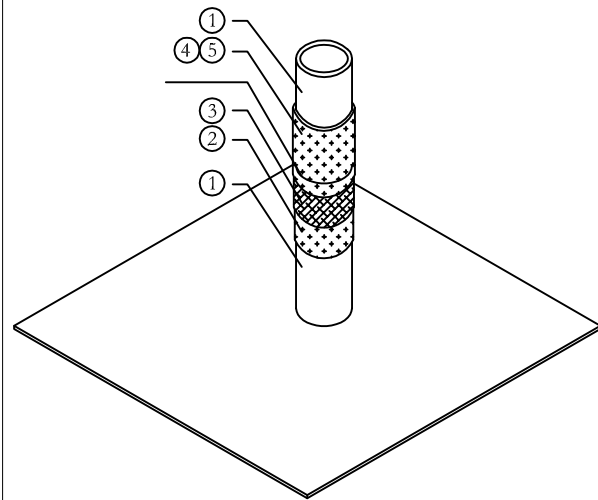

A LIQUID FLASHING REINFORCEMENT; PIPE SUPPORT
1 N.T.S.

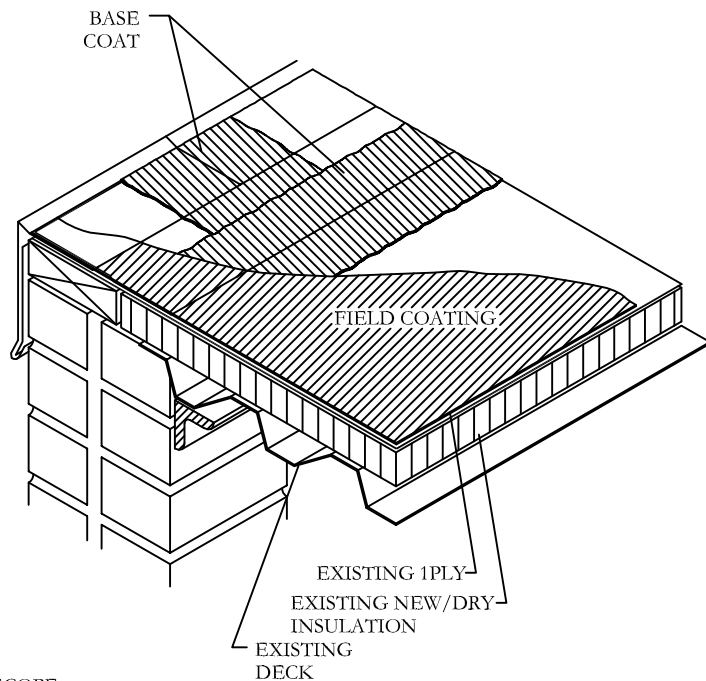

SCOPE
1. METAL EDGE JOINTS AND MEMBRANE LAPS REINFORCED W/ BASE COAT.
2. FIELD COATING APPLIED OVER ENTIRE ROOF SURFACE.

A LIQUID APPLIED MEMBRANE AT EDGE
2 N.T.S.

- 1 GRIND/SCRAPE OFF ALL COATINGS & SEALANTS FROM METAL PIPE & MEMBRANE, MASK TARGET AREA ON PIPE & MEMBRANE WITH TAPE, AND CLEAN WITH ISOPROPYL ALCOHOL
- 2 APPLY 32 WET MIL BASE COAT OF LIQUID FLASHING COATING OVER MASKED AREA
- 3 EMBED POLYESTER INTO BASE COAT.
- 4 APPLY 32 WET MIL TOP COAT OF LIQUID FLASHING COATING OVER POLYESTER EXTENDING 2" PAST THE SCRIM IN ALL DIRECTIONS
- 5 APPLY TWO COATS REFLECTIVE SURFACING AFTER 15-30 DAYS CURE

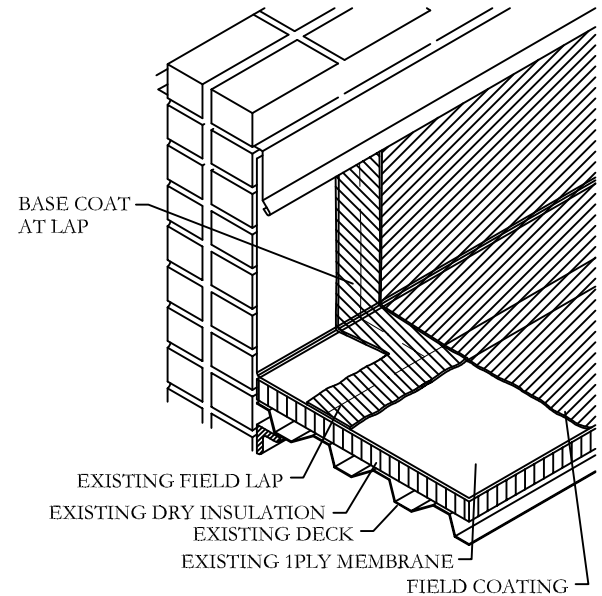

NOTES:
1. BASE COAT: TWO (2) GALLONS/SQUARE BASE COAT, ALLOW 48 HOUR CURE.
2. TOP COAT: FIELD COATING OVER BASE COAT AT 2 GALLONS/SQUARE.

A FLASHING LAP REPAIR
3 N.T.S.

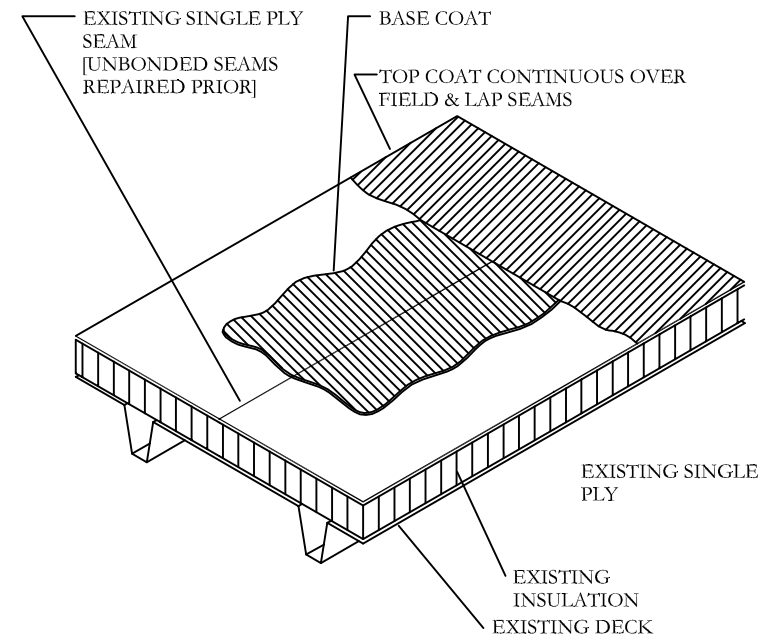

NOTES;
1. LAP SEAMS: BASE COAT AT 2.0 GAL/SQ, 8" WIDE OVER THE SEAM. ALLOW 24 HOUR CURE.
2. FIELD & LAP SEAMS: TOP COAT AT 2 GAL/SQ.

A LIQUID MEMBRANE AT FIELD AND LAP SEAMS
4 N.T.S.

BALDWIN COUNTY COMMISSION
BOE ADMINISTRATION BUILDING
BAY MINETTE, ALABAMA 36507

DRAWN
P.J.
CHECKED
T.T.
DATE
10/04/2018
SCALE
1/32"=1'0"

SHEET

A-1

1-OF-2 SHEETS