

BAR CODE SPORTS BAR AND LOUNGE, LLC
dba BAR CODE SPORTS BAR AND LOUNGE
9402 UPPER BRYANTS LANDING RD.,
STOCKTON, AL 36579
ABC LICENSE

0 125 250 500 Feet

The information contained in this representation of digital data distributed by the Baldwin County Commission's Planning and Zoning Department is derived from a variety of public and private sources and is considered to be dependable. However, the accuracy, completeness, and currency thereof are not guaranteed. The Baldwin County Commission makes no warranties, expressed or implied, as to the accuracy, completeness, currency, reliability, or suitability of information or data contained in or generated from the County Geographic Database for any particular purpose. Additionally, the Baldwin County Commission or any agent, servant, or employee thereof assume no liability associated with the use of this data, and assume no responsibility to maintain it in any manner or form. For more information concerning this map call 251-552-1655.

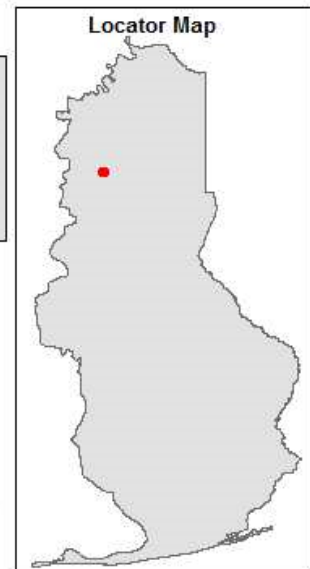

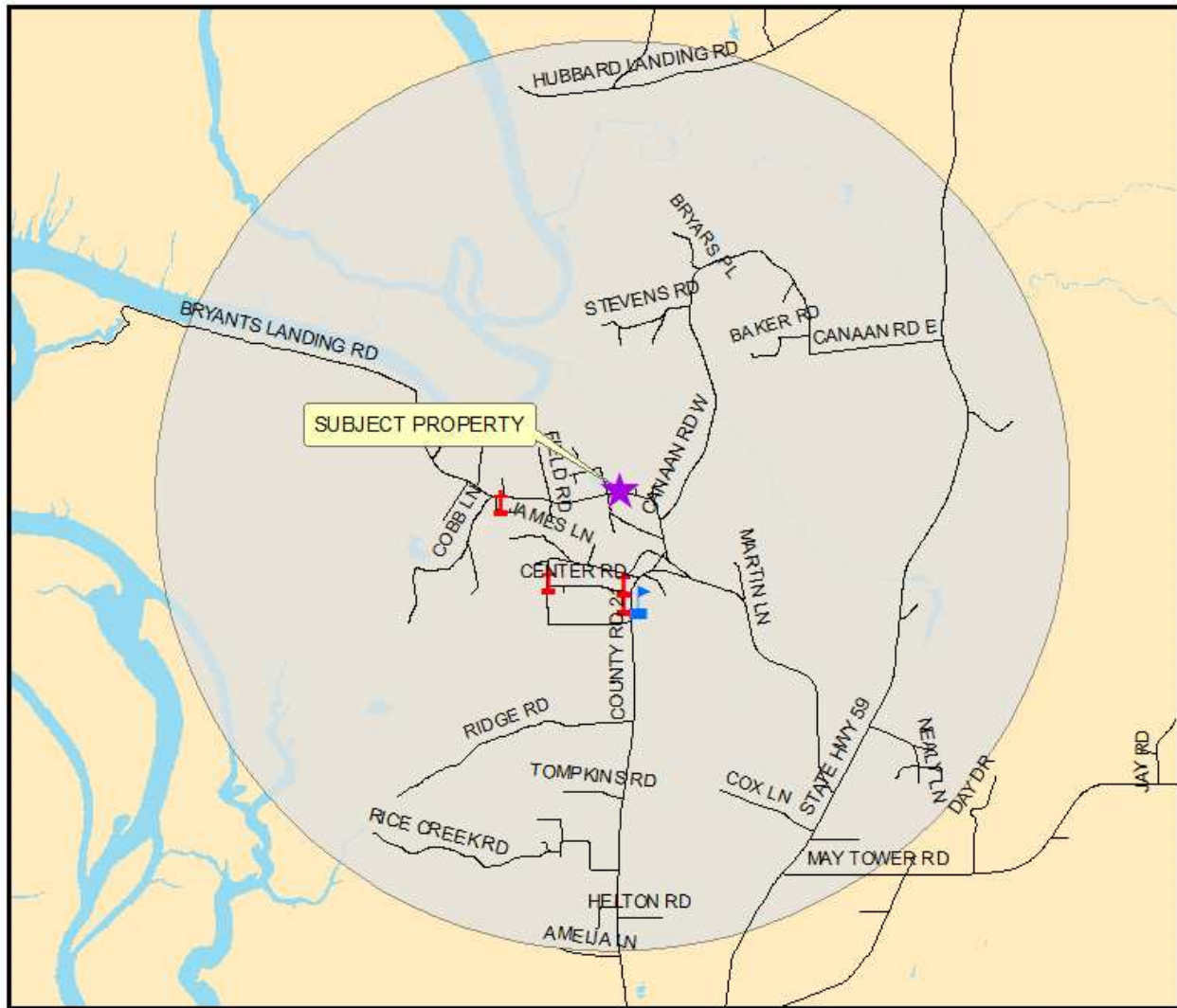

BALDWIN COUNTY COMMISSION
PLANNING AND ZONING DEPARTMENT



BAR CODE SPORTS BAR AND LOUNGE, LLC
dba BAR CODE SPORTS BAR AND LOUNGE
9402 UPPER BRYANTS LANDING RD.,
STOCKTON, AL 36579
ABC LICENSE

0 0.5 1 2 Miles

Locator Map

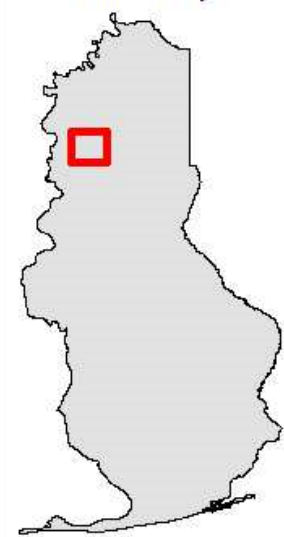

The information contained in this representation of digital data distributed by the Baldwin County Commission's Planning and Zoning Department is derived from a variety of public and private sources and is considered to be dependable. However, the accuracy, completeness, and currency thereof are not guaranteed. The Baldwin County Commission makes no warranties, expressed or implied, as to the accuracy, completeness, currency, reliability, or suitability of information or data contained in or generated from the County Geographic Database for any particular purpose. Additionally, the Baldwin County Commission or any agent, servant, or employee thereof assume no liability associated with the use of this data, and assume no responsibility to maintain it in any matter or form. For more information concerning this map call 251.350.1835.

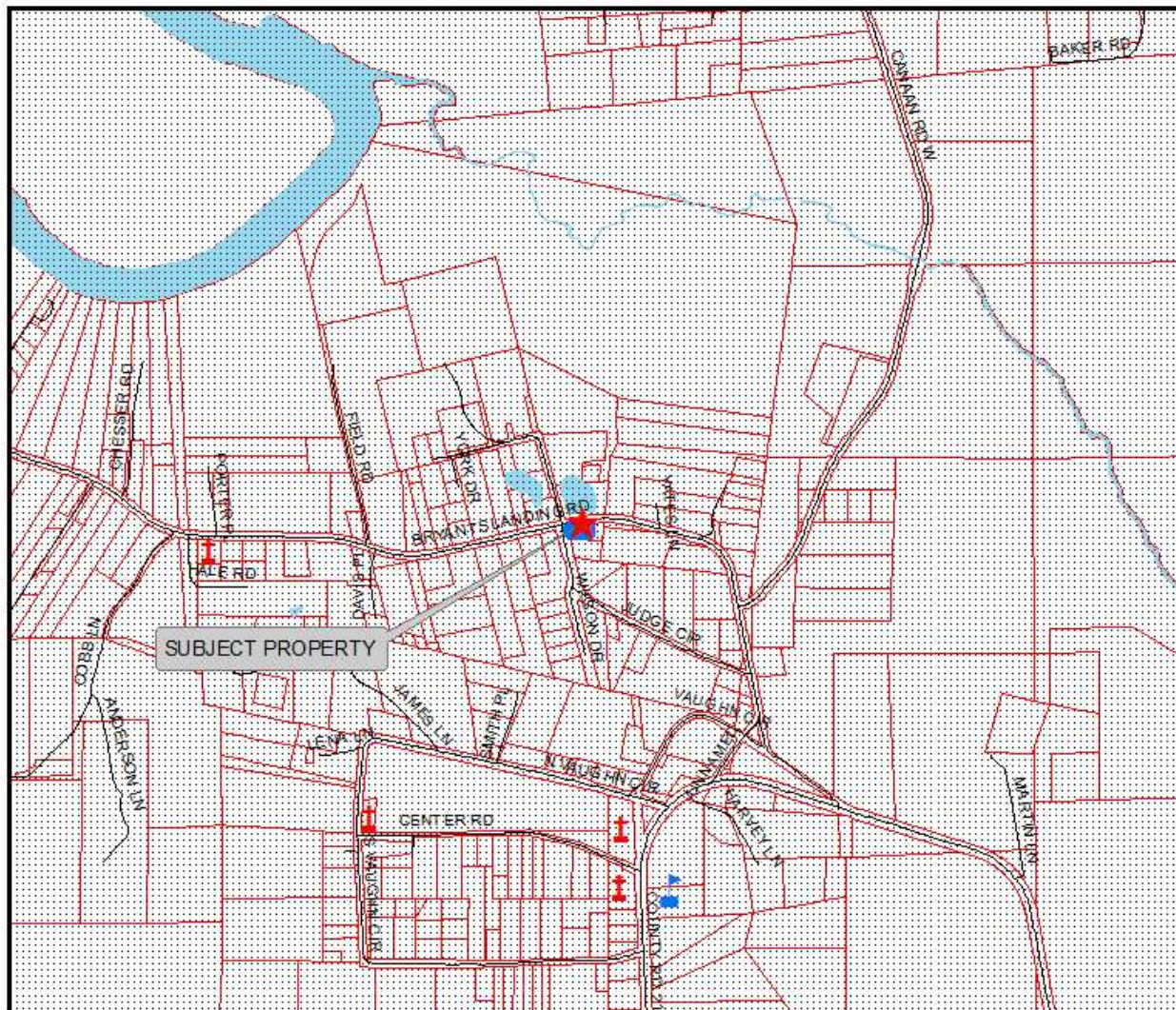

BALDWIN COUNTY COMMISSION
PLANNING AND ZONING DEPARTMENT



BAR CODE SPORTS BAR AND LOUNGE, LLC
dba BAR CODE SPORTS BAR AND LOUNGE
9402 UPPER BRYANTS LANDING RD.,
STOCKTON, AL 36579
ABC LICENSE

0 600 1,200 2,400
Feet

Place of Worship	Conservation Resource District (CR)	Marine Recreation District (MR)
School Locations	Residential Single Family Estate District (RSF-E)	Outdoor Recreation District (OR)
Unincorporated Baldwin County	Residential Single Family District (RSF-1)	Tourist Resort District (TR)
Roads	Residential Single Family District (RSF-2)	Professional Business District (B-1)
Water	Residential Single Family District (RSF-3)	Neighborhood Business District (B-2)
City Limits	Residential Single Family District (RSF-4)	General Business District (B-3)
Parcels	Residential Two Family District (RTF-4)	Major Commercial District (B-4)
Rural District (RR)	Residential Single Family District (RSF-6)	Light Industrial District (M-1)
Rural Agricultural District (RA)	Residential Two Family District (RTF-6)	General Industrial District (M-2)
	Residential Multiple Family District (RMF-6)	
	Residential Manufactured Housing Park District (RMH)	

The information contained in this representation of digital data distributed by the Baldwin County Commission's Planning and Zoning Department is derived from a variety of public and private sources and is considered to be dependable. However, the accuracy, completeness, and currency thereof are not guaranteed. The Baldwin County Commission makes no warranties, expressed or implied, as to the accuracy, completeness, currency, reliability, or suitability of information or data contained in or generated from the County Geographic Database for any particular purpose. Additionally, the Baldwin County Commission or any agent, servant, or employee thereof assumes no liability associated with the use of this data, and assumes no responsibility to maintain it in any manner or form. For more information concerning this map call 251.550.1655.

Locator Map

