

Holiday 8

Point Clear, Alaba

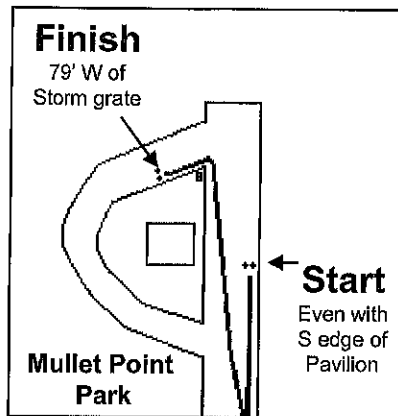

Splits: Marked with one washer and green paint.
Mile 1: Near 12483, 24' S of pole 5
Mile 2: Near 11831, 10' N of fire plug
Mile 3: Near 11861, 16' N of pole 105
Mile 4: Near 12501, 39' N of pole 14

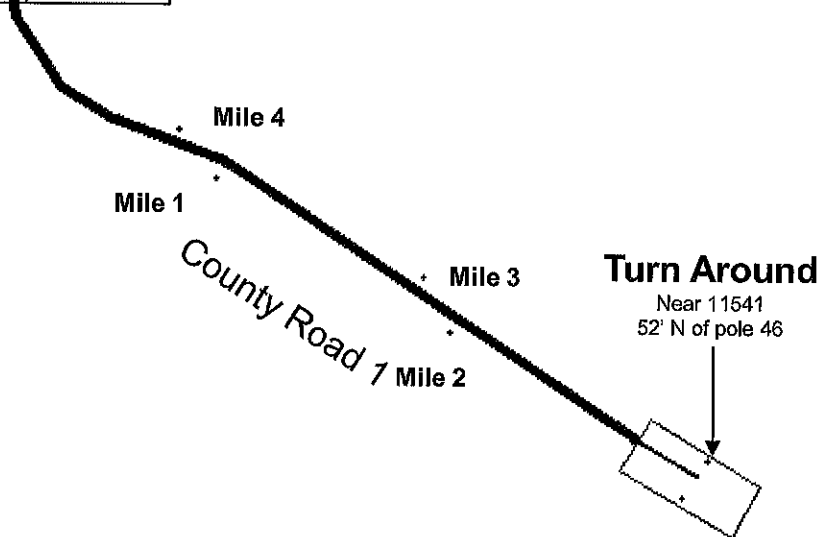

Start, Finish, and Turn-around marked with
washers and green paint

Measured by Jon Bowie (Daphne, AL 251-209-0887)
jnbowie@gmail.com
07 November 2010
Race contact: Port City Pacers 251-473-7223

No Diagrams to Scale